



## Part-turn actuators

SQ 05.2 – SQ 14.2/SQR 05.2 – SQR 14.2

Control unit: electronic (MWG)

with actuator controls

AUMATIC AC 01.2 Non-Intrusive

### Control

→ Parallel

Profibus DP

Modbus

Foundation Fieldbus



### Read operation instructions first.

- Observe safety instructions.
- These operation instructions are part of the product.
- Retain operation instructions during product life.
- Pass on instructions to any subsequent user or owner of the product.

### Purpose of the document:

This document contains information for installation, commissioning, operation and maintenance staff. It is intended to support device installation and commissioning.

### Reference documents:

- Manual (Operation and setting) AUMATIC AC 01.2 Parallel

Reference documents can be downloaded from the Internet ([www.auma.com](http://www.auma.com)) or ordered directly from AUMA (refer to <Addresses>).

Table of contents	Page
<b>1. Safety instructions.....</b>	<b>5</b>
1.1. Basic information on safety	5
1.2. Range of application	5
1.3. Applications in Ex zone 22 (option)	6
1.4. Warnings and notes	6
1.5. References and symbols	7
<b>2. Identification.....</b>	<b>8</b>
2.1. Name plate	8
2.2. Short description	9
<b>3. Transport, storage and packaging.....</b>	<b>11</b>
3.1. Transport	11
3.2. Storage	11
3.3. Packaging	11
<b>4. Assembly.....</b>	<b>12</b>
4.1. Mounting position	12
4.2. Handwheel fitting	12
4.3. Actuator: mount to valve	12
4.4. Mounting positions of local controls	14
4.4.1 Mounting positions: modify	14
<b>5. Electrical connection.....</b>	<b>15</b>
5.1. Basic information	15
5.2. Connection with AUMA plug/socket connector	16
5.2.1 Terminal compartment: open	17
5.2.2 Cable connection	17
5.2.3 Terminal compartment: close	19
5.3. Accessories for electrical connection	19
5.3.1 Controls mounted to wall bracket	19
5.3.2 Parking frame	20
5.3.3 Protection cover	21
5.3.4 Double sealed intermediate frame	21
5.3.5 Earth connection, external	21

<b>6.</b>	<b>Operation.....</b>	<b>22</b>
6.1.	Manual operation	22
6.1.1	Manual operation: engage	22
6.1.2	Manual operation: disengage	22
6.2.	Motor operation	22
6.2.1	Local actuator operation	22
6.2.2	Actuator operation from remote	23
6.3.	Menu navigation via push buttons (for settings and indications)	23
6.3.1	Menu layout and navigation	24
6.4.	User level, password	25
6.4.1	Password entry	26
6.4.2	Password change	26
6.5.	Language in the display	27
6.5.1	Language change	27
<b>7.</b>	<b>Indications.....</b>	<b>29</b>
7.1.	Indications during commissioning	29
7.2.	Indications in the display	29
7.2.1	Feedback indications from actuator and valve	30
7.2.2	Status indications according to AUMA classification	33
7.2.3	Status indications according to NAMUR recommendation	34
7.3.	Mechanical position indicator/running indication	35
7.4.	Indication lights	36
<b>8.</b>	<b>Signals.....</b>	<b>37</b>
8.1.	Status signals via output contacts (digital outputs)	37
8.1.1	Assignment of outputs	37
8.1.2	Encoding of outputs	37
8.2.	Analogue signals	37
<b>9.</b>	<b>Commissioning (basic settings).....</b>	<b>38</b>
9.1.	End stops in part-turn actuator	38
9.1.1	End stop CLOSED: set	39
9.1.2	End stop OPEN: set	39
9.2.	Type of seating: set	40
9.3.	Torque switching: set	41
9.4.	Limit switching: set	43
9.5.	Test run	44
9.5.1	Direction of rotation: check	45
9.5.2	Limit switching: check	45
9.6.	Mechanical position indicator: set	45
9.7.	Switch compartment: close	46
<b>10.</b>	<b>Corrective action.....</b>	<b>47</b>
10.1.	Faults during commissioning	47
10.2.	Fault indications and warning indications	47
10.3.	Fuses	50
10.3.1	Fuses within the actuator controls	50
10.3.2	Motor protection (thermal monitoring)	52
<b>11.</b>	<b>Servicing and maintenance.....</b>	<b>53</b>
11.1.	Preventive measures for servicing and safe operation	53
11.2.	Maintenance	53

11.3.	Disposal and recycling	53
<b>12.</b>	<b>Technical data.....</b>	<b>55</b>
12.1.	Features and functions of actuator	55
12.2.	Features and functions of actuator controls	56
12.3.	Service conditions	59
12.4.	Accessories	59
12.5.	Further information	59
<b>13.</b>	<b>Spare parts.....</b>	<b>60</b>
13.1.	Part-turn actuators SQ 05.2 – SQ 14.2/SQR 05.2 – SQR 14.2	60
13.2.	Actuator controls AUMATIC AC 01.2	62
<b>14.</b>	<b>Certificates.....</b>	<b>64</b>
14.1.	Declaration of Incorporation and EC Declaration of Conformity	64
<b>15.</b>	<b>Index.....</b>	<b>67</b>
	<b>Addresses.....</b>	<b>69</b>

## 1. Safety instructions

### 1.1 Basic information on safety

<b>Standards/directives</b>	<p>AUMA products are designed and manufactured in compliance with recognised standards and directives. This is certified in a Declaration of Incorporation and an EC Declaration of Conformity.</p> <p>The end user or the contractor must ensure that all legal requirements, directives, guidelines, national regulations and recommendations with respect to assembly, electrical connection, commissioning and operation are met at the place of installation.</p>
<b>Safety instructions/warnings</b>	<p>All personnel working with this device must be familiar with the safety and warning instructions in this manual and observe the instructions given. Safety instructions and warning signs on the device must be observed to avoid personal injury or property damage.</p>
<b>Qualification of staff</b>	<p>Assembly, electrical connection, commissioning, operation, and maintenance must be carried out exclusively by suitably qualified personnel having been authorised by the end user or contractor of the plant only.</p> <p>Prior to working on this product, the staff must have thoroughly read and understood these instructions and, furthermore, know and observe officially recognised rules regarding occupational health and safety.</p>
<b>Commissioning</b>	<p>Prior to commissioning, it is important to check that all settings meet the requirements of the application. Incorrect settings might present a danger to the application, e.g. cause damage to the valve or the installation. The manufacturer will not be held liable for any consequential damage. Such risk lies entirely with the user.</p>
<b>Operation</b>	<p>Prerequisites for safe and smooth operation:</p> <ul style="list-style-type: none"> <li>• Correct transport, proper storage, mounting and installation, as well as careful commissioning.</li> <li>• Only operate the device if it is in perfect condition while observing these instructions.</li> <li>• Immediately report any faults and damage and allow for corrective measures.</li> <li>• Observe recognised rules for occupational health and safety.</li> <li>• Observe the national regulations.</li> <li>• During operation, the housing warms up and surface temperatures &gt; 60 °C may occur. To prevent possible burns, we recommend checking the surface temperature using an appropriate thermometer and wearing protective gloves, if required, prior to working on the device.</li> </ul>
<b>Protective measures</b>	<p>The end user or the contractor are responsible for implementing required protective measures on site, such as enclosures, barriers, or personal protective equipment for the staff.</p>
<b>Maintenance</b>	<p>To ensure safe device operation, the maintenance instructions included in this manual must be observed.</p> <p>Any device modification requires prior consent of the manufacturer.</p>

### 1.2 Range of application

AUMA part-turn actuators are designed for the operation of industrial valves, e.g. butterfly valves and ball valves.

Other applications require explicit (written) confirmation by the manufacturer.

The following applications are not permitted, e.g.:

- Industrial trucks according to EN ISO 3691
- Lifting appliances according to EN 14502
- Passenger lifts according to DIN 15306 and 15309
- Service lifts according to EN 81-1/A1

- Escalators
- Continuous duty
- Buried service
- Permanent submersion (observe enclosure protection)
- Potentially explosive areas, with the exception of zone 22
- Radiation exposed areas in nuclear power plants

No liability can be assumed for inappropriate or unintended use.

Observance of these operation instructions is considered as part of the device's designated use.

**Information** These operation instructions are only valid for the "clockwise closing" standard version, i.e. driven shaft turns clockwise to close the valve.

### 1.3 Applications in Ex zone 22 (option)

Actuators of the indicated series basically meet the requirements for applications in dust hazardous locations of ZONE 22 in compliance with the ATEX directive 94/9/EC.

The actuators are designed to meet enclosure protection IP 68 and fulfil the requirements of EN 50281-1-1:1998 section 6 - Electrical apparatus for use in presence of combustible dust, requirements for category 3 electrical equipment - protected by enclosures.

To comply with all requirements of EN 50281-1-1:1998, it is imperative that the following points are observed:

- In compliance with the ATEX directive 94/9/EC, the actuators must be equipped with an additional identification – II3D IP6X T150 °C.
- The maximum surface temperature of the actuators, based on an ambient temperature of +40 °C in accordance with EN 50281-1-1 section 10.4, is +150 °C. In accordance with section 10.4, an increased dust deposit on the equipment was not considered for the determination of the maximum surface temperature.
- The correct connection of the thermoswitches or the PTC thermistors as well as fulfilling the requirements of the duty type and the technical data are prerequisites for compliance with the maximum surface temperature of devices.
- The connection plug may only be plugged in or pulled out when device is disconnected from the mains.
- The cable glands used also have to meet the requirements of category II3 D and must at least comply with enclosure protection IP 68.
- The actuators must be connected by means of an external ground connection (accessory part) to the potential compensation or integrated into an earthed piping system.
- As a general rule, the requirements of EN 50281-1-1 must be respected in dust hazardous locations. During commissioning, service, and maintenance, special care as well as qualified and trained personnel are required for the safe operation of actuators.

### 1.4 Warnings and notes

The following warnings draw special attention to safety-relevant procedures in these operation instructions, each marked by the appropriate signal word (DANGER, WARNING, CAUTION, NOTICE).



**Indicates an imminently hazardous situation with a high level of risk. Failure to observe this warning could result in death or serious injury.**



**Indicates a potentially hazardous situation with a medium level of risk. Failure to observe this warning could result in death or serious injury.**



Indicates a potentially hazardous situation with a low level of risk. Failure to observe this warning may result in minor or moderate injury. May also be used with property damage.



Potentially hazardous situation. Failure to observe this warning may result in property damage. Is not used for personal injury.

### Arrangement and typographic structure of the warnings



#### Type of hazard and respective source!

*Potential consequence(s) in case of non-observance (option)*

- Measures to avoid the danger
- Further measure(s)

Safety alert symbol  warns of a potential personal injury hazard.

The signal word (here: DANGER) indicates the level of hazard.

## 1.5 References and symbols

The following references and symbols are used in these instructions:

**Information** The term **Information** preceding the text indicates important notes and information.

 Symbol for CLOSED (valve closed)

 Symbol for OPEN (valve open)

✓ Important information before the next step. This symbol indicates what is required for the next step or what has to be prepared or observed.

**M ▶ Via the menu to parameter**

Describes the path within the menu to the parameter. By using the push buttons of the local controls you may quickly find the desired parameter in the display.

**< > Reference to other sections**

Terms in brackets shown above refer to other sections of the document which provide further information on this topic. These terms are either listed in the index, a heading or in the table of contents and may quickly be found.

## 2. Identification

### 2.1 Name plate

Each device component (actuator, controls, motor) is equipped with a name plate.

Figure 1: Arrangement of name plates

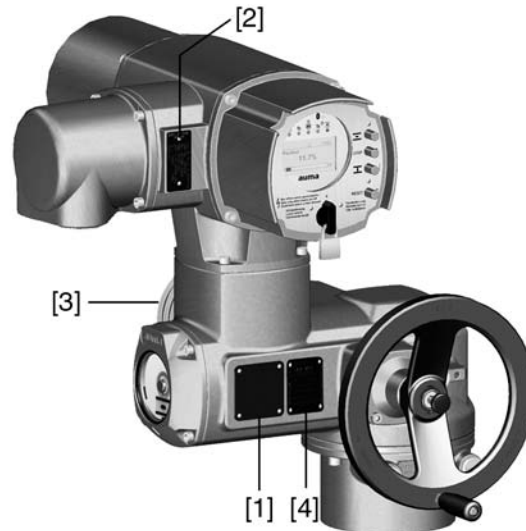

- [1] Actuator name plate
- [2] Controls name plate
- [3] Motor name plate
- [4] Additional plate, e.g. KKS plate (Power Plant Classification System)

### Description of actuator name plate

Figure 2: Actuator name plate (example)

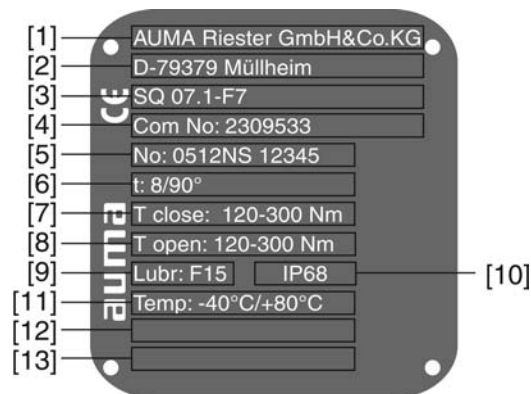

- [1] Name of manufacturer
- [2] Address of manufacturer
- [3] **Type designation** (see explanation below)
- [4] **Commission number** (see explanation below)
- [5] Actuator series number
- [6] Operating time in [s] for a part-turn movement of 90°
- [7] Torque range in direction CLOSE
- [8] Torque range in direction OPEN
- [9] Lubricant type – [10] enclosure protection
- [11] Permissible ambient temperature
- [12] Can be assigned as an option upon customer request
- [13] Can be assigned as an option upon customer request



**Type designation** Figure 3: Type designation (example)

**SQ 07.2 - F7**

1. 2.

1. Type and size of actuator
2. Flange size

#### Type and size

These instructions apply to the following devices types and sizes:

Part-turn actuators for open-close duty: SQ 05.2, 07.2, 10.2, 12.2, 14.2

Part-turn actuators for modulating duty: SQR 05.2, 07.2, 10.2, 12.2, 14.2

**Commission number** An order-relevant commission number (order number) is assigned to each device. This commission number can be used to directly download the wiring diagram (in German and English language), inspection records and further information regarding the device from the Internet: <http://www.auma.com>. For some details, the customer number might be required.

**Actuator series number** Table 1: Description of series number (with example)

05	12	N S 12345	
1 <sup>st</sup> + 2 <sup>nd</sup> position: Assembly in week			
05	In our example: Week 05		
3 <sup>rd</sup> + 4 <sup>th</sup> position: Year of manufacture			
	12	In our example: Year of manufacture: 2012	
All other positions			
		N S 12345	Internal works number for unambiguous product identification

#### Description of controls name plate

Figure 4: Controls name plate

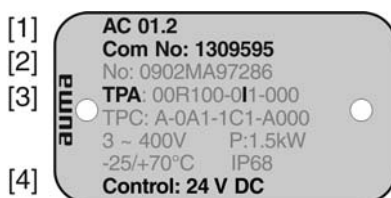

- [1] **Type designation**
- [2] **Commission number**
- [3] **Wiring diagram**
- [4] **Control**

**Type designation** AC 01.2 = actuator controls AUMATIC

**Wiring diagram** 9<sup>th</sup> position in the **TPA** wiring diagram: Position transmitter (actuator):

Electronic control unit:

**I, Q** = MWG (Magnetic limit and torque transmitter)

**Control** **24 V DC** = Control via parallel interface at 24 V DC control voltage

**115 V AC** = Control via parallel interface at 115 V AC control voltage

**0/4 – 20 mA** = Control via parallel interface via analogue input 0/4 – 20 mA

## 2.2 Short description

**Part-turn actuator** Definition in compliance with EN ISO 5211:

A part-turn actuator is an actuator which transmits a torque to the valve for less than one full revolution. It need not be capable of withstanding thrust.

	<p>AUMA part-turn actuators are driven by an electric motor. A handwheel is provided for manual operation. Switching off in end positions may be either by limit or torque seating. Controls are required to operate or process the actuator signals.</p>
<b>Actuator controls</b>	<p>The AUMATIC actuator controls are used to operate AUMA actuators and are supplied ready for use. The controls may be mounted directly to the actuator or separately on a wall bracket.</p> <p>The functions of the AUMATIC controls include standard valve control in OPEN - CLOSE duty, positioning, process control, logging of operating data right through to diagnostic functions.</p>
<b>Local controls/AUMA CDT</b>	<p>Operation, setting, and display can be performed on site directly at the controls.</p> <p>When set to local control, it is possible to</p> <ul style="list-style-type: none"> <li>operate the actuator via the local controls (push buttons and display) and perform settings (contents of these instructions).</li> <li>read in or out data or modify and save settings via the AUMA CDT software (option), using a computer (laptop or PC). The connection between computer and AUMATIC is wireless via Bluetooth interface (not included in these instructions).</li> </ul>
<b>Intrusive - Non-Intrusive</b>	<ul style="list-style-type: none"> <li>Intrusive version (control unit: electromechanical): Limit and torque setting is performed via switches in the actuator.</li> <li>Non-Intrusive version (control unit: electronic): Limit and torque setting is performed via the controls, actuator and controls housings do not have to be opened. For this purpose, the actuator is equipped with an MWG (magnetic limit and torque transmitter), also supplying analogue torque feedback signals/torque indication and analogue position feedback signals/position indication.</li> </ul>

### 3. Transport, storage and packaging

#### 3.1 Transport

For transport to place of installation, use sturdy packaging.



##### **Hovering load!**

*Risk of death or serious injury.*

- Do NOT stand below hovering load.
- Attach ropes or hooks for the purpose of lifting by hoist only to housing and NOT to handwheel.
- Actuators mounted on valves: Attach ropes or hooks for the purpose of lifting by hoist to valve and NOT to actuator.
- Actuators mounted to gearboxes: Attach ropes or hooks for the purpose of lifting by hoist only to the gearbox using eyebolts and NOT to the actuator.
- Actuators mounted to controls: Attach ropes or hooks for the purpose of lifting by hoist only to the actuator and NOT to the controls.

#### 3.2 Storage

##### **NOTICE**

##### **Danger of corrosion due to inappropriate storage!**

- Store in a well-ventilated, dry room.
- Protect against floor dampness by storage on a shelf or on a wooden pallet.
- Cover to protect against dust and dirt.
- Apply suitable corrosion protection agent to uncoated surfaces.

##### **NOTICE**

##### **Damage on display caused by temperatures below permissible level!**

- The AUMATIC actuator controls must NOT be stored below –30 °C.

##### **Long-term storage**

If the device must be stored for a long period (more than 6 months) the following points must be observed in addition:

1. Prior to storage:  
Protect uncoated surfaces, in particular the output drive parts and mounting surface, with long-term corrosion protection agent.
2. At an interval of approx. 6 months:  
Check for corrosion. If first signs of corrosion show, apply new corrosion protection.

#### 3.3 Packaging

Our products are protected by special packaging for transport when leaving the factory. The packaging consists of environmentally friendly materials which can easily be separated and recycled. We use the following packaging materials: wood, cardboard, paper, and PE foil. For the disposal of the packaging material, we recommend recycling and collection centres.

## 4. Assembly

### 4.1 Mounting position

AUMA actuators and actuator controls can be operated without restriction in any mounting position.

### 4.2 Handwheel fitting

**Information** For transport purposes, handwheels from a diameter of 400 mm are supplied separately.

Figure 5: Handwheel

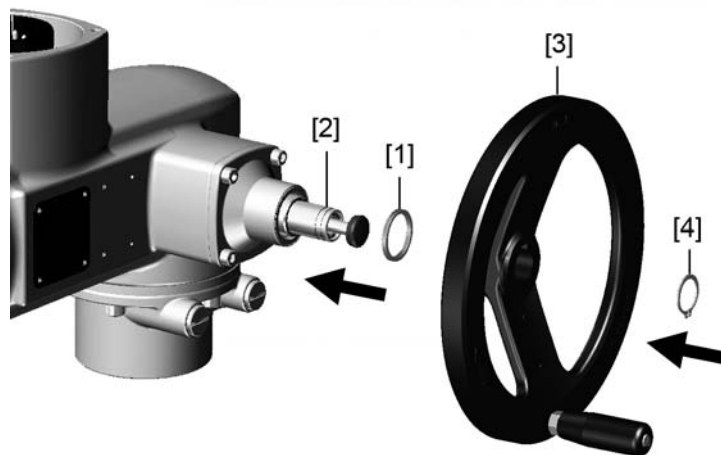

- [1] Spacer
- [2] Input shaft
- [3] Handwheel
- [4] Circlip

1. If required, fit spacer [1] onto input shaft [2].
2. Slip handwheel [3] onto input shaft.
3. Secure handwheel [3] using the circlip [4] supplied.

### 4.3 Actuator: mount to valve

#### NOTICE

#### **Danger of corrosion due to damage to paint finish and condensation!**

- Touch up damage to paint finish after work on the device.
- After mounting, connect the device immediately to electrical mains to ensure that heater minimises condensation.

The actuator is mounted to the valve using a coupling.

Figure 6: Coupling fitting dimensions

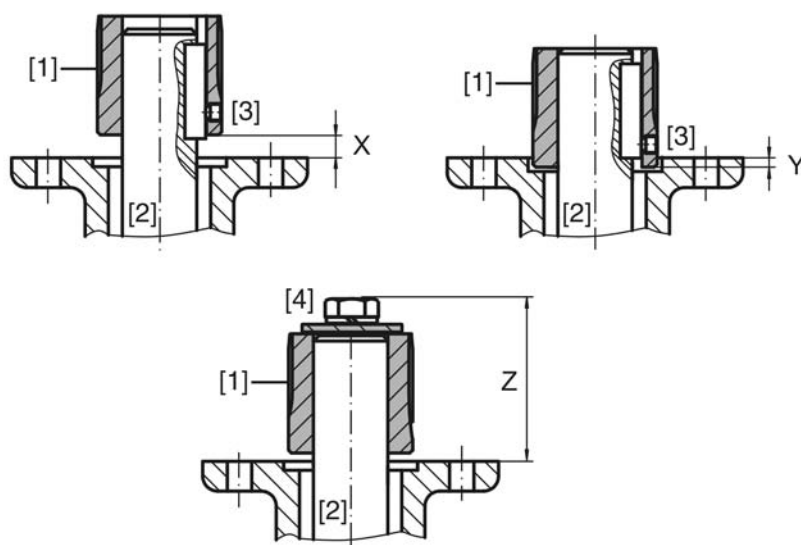

- [1] Coupling
- [2] Valve shaft
- [3] Grub screw
- [4] Screw

Table 2: Coupling fitting dimensions

Type, size - mounting flange	X max [mm]	Y max [mm]	Z max [mm]
SQ/SQR 05.2-F05	9	—	60
SQ/SQR 05.2-F07	9	—	60
SQ/SQR 07.2-F07	9	—	60
SQ/SQR 07.2-F10	24	—	75
SQ/SQR 10.2-F10	15	9	77
SQ/SQR 10.2-F12	32	—	97
SQ/SQR 12.2-F12	25	—	100
SQ/SQR 12.2-F14	45	—	120
SQ/SQR 14.2-F14			
SQ/SQR 14.2-F16			

1. Use handwheel to run actuator to mechanical end stop.  
**Information:** Assemble valve and actuator in the same end position.
  - For butterfly valves: Recommended mounting position is end position CLOSED.
  - For ball valves: Recommended mounting position is end position OPEN.
2. Thoroughly degrease mounting faces of the mounting flanges.
3. Apply a small quantity of grease to the valve shaft [2].
4. Place coupling [1] onto valve shaft [2] and secure against axial slipping by using a grub screw, a circlip or a screw. Thereby, ensure that dimensions X, Y or Z are observed (refer to figure and table <Coupling fitting dimensions>).
5. Apply non-acidic grease at splines of coupling.
6. Fit actuator.  
**Information:** Ensure that the spigot (if provided) fits uniformly in the recess and that the flanges are in complete contact.
7. If flange bores do not match thread:
  - 7.1 Slightly rotate handwheel until bores line up.
  - 7.2 If required, shift actuator position by one tooth on the coupling.

8. Fasten actuator with screws [4].

**Information:** We recommend applying liquid thread sealing material to the screws to avoid contact corrosion.

→ Fasten screws [4] crosswise with a torque according to table.

Table 3: Tightening torques for screws

Screws Threads	Tightening torque $T_A$ [Nm]
	Strength class 8.8
M6	11
M8	25
M10	51
M12	87
M16	211

#### 4.4 Mounting positions of local controls

The mounting position of the local controls is selected according to the order. If, after mounting the actuator to the valve or the gearbox on site, the local controls are in an unfavourable position, the mounting position can be changed at a later date. Four mounting positions are possible.

##### 4.4.1 Mounting positions: modify



#### Hazardous voltage!

*Risk of electric shock.*

→ Disconnect device from the mains before opening.



#### Electrostatic discharge ESD!

*Risk of damage to electronic components.*

→ Earth both operators and devices.

1. Loosen screws and remove the local controls.
2. Check whether O-ring is in good condition, correctly insert O-ring.
3. Turn local controls into new position and re-place.



#### Cable damage due to twisting or pinching!

*Risk of functional failures.*

- Turn local controls by a maximum of 180°.
- Carefully assemble local controls to avoid pinching the cables.

4. Fasten screws evenly crosswise.

## 5. Electrical connection

### 5.1 Basic information



**WARNING**

#### Danger due to incorrect electrical connection

*Failure to observe this warning can result in death, serious injury, or property damage.*

- The electrical connection must be carried out exclusively by suitably qualified personnel.
- Prior to connection, observe basic information contained in this chapter.
- After connection but prior to applying the voltage, observe the <Commissioning> and <Test run> chapters.

#### Wiring diagram/terminal plan

The pertaining wiring diagram/terminal plan (in German and English language) is attached to the device in a weather-proof bag, together with these operation instructions. It can also be obtained from AUMA (state commission no., refer to name plate) or downloaded directly from the Internet ([www.auma.com](http://www.auma.com)).

#### Permissible networks (supply networks)

The controls (actuators) are suitable for use in TN and TT networks with directly earthed star point and a maximum voltage of 690 V AC. Use in IT networks is permitted while observing the respective <Protection on site> for maximum supply voltages of 600 V AC.

#### Protection on site

For short-circuit protection and for disconnecting the actuator from the mains, fuses and disconnect switches have to be provided by the customer.

The current values for respective sizing is derived from the current consumption of the motor (refer to electrical data sheet) plus the current consumption of the controls.

Table 4: Current consumption controls

Mains voltage	Max. current consumption	
Permissible variation of the mains voltage	±10 %	–30 %
100 to 120 V AC	750 mA	1,200 mA
208 to 240 V AC	400 mA	750 mA
380 to 500 V AC	250 mA	400 mA
515 to 690 V AC	200 mA	400 mA

Table 5: Maximum permissible protection

Switchgear	Rated power	max. protection
Reversing contactor A1	up to 1.5 kW	16 A (gL/gG)
Thyristor	up to 1.5 kW	16 A (g/R) $I^2t < 1,500A^2s$

If controls are mounted separately from actuator (controls on wall bracket): Consider length and cross section of connecting cable when defining the protection required.

Use appropriate insulation monitors when working in power installations, for example an insulation monitor measuring the pulse code.

#### Power supply for the controls (electronics)

In case of external supply of the controls (electronics): The external power supply must have a reinforced insulation against the mains voltage in accordance with IEC 61010-1 and may only be supplied by a circuit limited to 150 VA in accordance with IEC 61010-1.

#### Potential of customer connections

All input signals (control) must be supplied with the same potential.

All output signals (status signals) must be supplied with the same potential.

#### Safety standards

All externally connected devices shall comply with the relevant safety standards.

#### Cable installation in accordance with EMC

Signal and bus cables are susceptible to interference.

Motor cables are interference sources.

- Lay cables being susceptible to interference or sources of interference at the highest possible distance from each other.
- The interference immunity of signal and bus cables increases if the cables are laid close to the earth potential.
- If possible, avoid laying long cables and make sure that they are installed in areas being subject to low interference.
- Avoid long parallel paths with cables being either susceptible to interference or interference sources.
- For the connection of remote position transmitters, screened cables must be used.

#### Type of current, mains voltage and mains frequency

Type of current, mains voltage and mains frequency must match the data on the motor name plate.

Figure 7: Motor name plate (example)

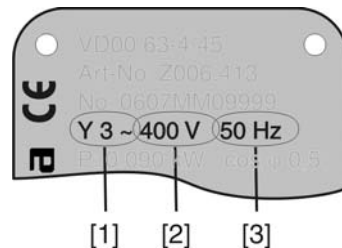

- [1] Type of current  
[2] Mains voltage  
[3] Mains frequency (for 3-ph and 1-ph AC motors)

#### Connecting cables

- For device insulation, appropriate (voltage-proof) cables must be used. Specify cables for the highest occurring rated voltage.
- Use connecting cable with appropriate minimum rated temperature.
- For connecting cables exposed to UV radiation (outdoor installation), use UV resistant cables.

## 5.2 Connection with AUMA plug/socket connector

### Cross sections AUMA plug/socket connector:

- Power terminals (U1, V1, W1, U2, V2, W2): max. 6 mm<sup>2</sup> flexible/10 mm<sup>2</sup> solid
- PE connection Ⓢ: max. 6 mm<sup>2</sup> flexible/10 mm<sup>2</sup> solid
- Control contacts (1 to 50): max. 2.5 mm<sup>2</sup>



### 5.2.1 Terminal compartment: open

Figure 8: Connection AUMA plug/socket connector, version S

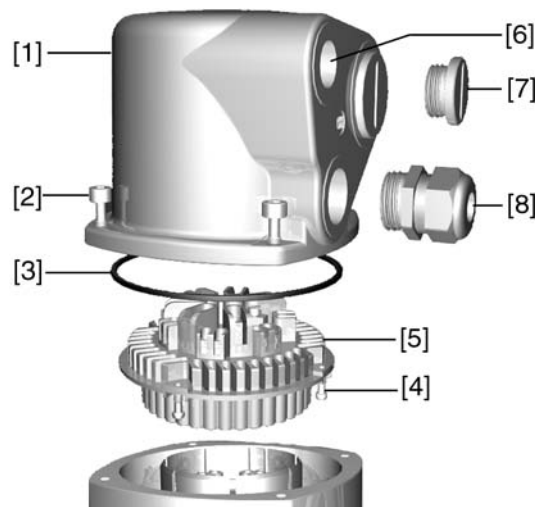

- [1] Cover
- [2] Screws for cover
- [3] O-ring
- [4] Screws for socket carrier
- [5] Socket carrier
- [6] Cable entry
- [7] Blanking plug
- [8] Cable gland (not included in delivery)



#### **Hazardous voltage!**

*Risk of electric shock.*

→ Disconnect device from the mains before opening.

1. Loosen screws [2] and remove cover [1].
2. Loosen screws [4] and remove socket carrier [5] from cover [1].
3. Insert cable glands [8] suitable for connecting cables.
- ➔ The enclosure protection IP... stated on the name plate is only ensured if suitable cable glands are used.

Figure 9: Example: Name plate shows enclosure protection IP 68



4. Seal unused cable entries [6] with suitable blanking plugs [7].
5. Insert the cables into the cable glands [8].

### 5.2.2 Cable connection

- ✓ Observe permissible cross sections.
- 1. Remove cable sheathing.
- 2. Strip wires.
- 3. For flexible cables: Use end sleeves according to DIN 46228.
- 4. Connect cables according to order-related wiring diagram.



**In case of a fault: Hazardous voltage while protective earth conductor is NOT connected!**

*Risk of electric shock.*

- Connect all protective earth conductors.
- Connect PE connection to external protective earth conductor of connecting cables.
- Start running the device only after having connected the protective earth conductor.

5. Tighten PE conductors firmly to PE connection using ring lugs (flexible cables) or loops (rigid cables).

Figure 10: PE connection

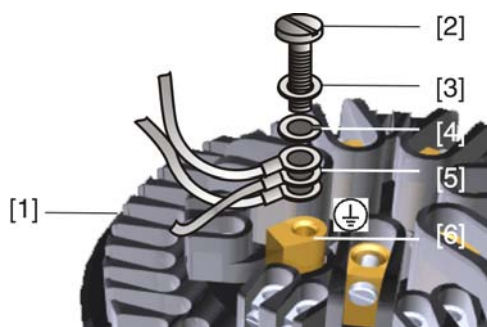

- [1] Socket carrier
- [2] Screw
- [3] Washer
- [4] Lock washer
- [5] Protective earth with ring lugs/loops
- [6] PE connection, symbol: ⚡

**NOTICE**

**Danger of corrosion: Damage due to condensation!**

- After mounting, commission the device immediately to ensure that heater minimises condensation.

**Information**

Some actuators are equipped with an additional motor heater. The motor heater minimises condensation within the motor and improves the start-up behaviour for extremely low temperatures.

### 5.2.3 Terminal compartment: close

Figure 11: Example: Version S

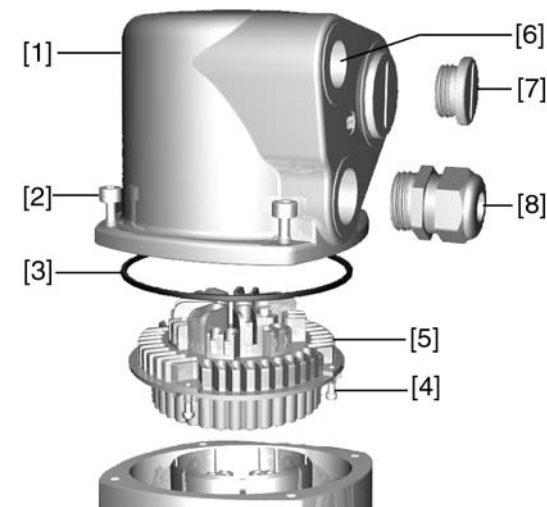

- [1] Cover
- [2] Screws for cover
- [3] O-ring
- [4] Screws for socket carrier
- [5] Socket carrier
- [6] Cable entry
- [7] Blanking plug
- [8] Cable gland (not included in delivery)



**WARNING**

#### Short-circuit due to pinching of cables!

*Risk of electric shock and functional failures.*

→ Carefully fit socket carrier to avoid pinching the cables.

1. Insert the socket carrier [5] into the cover [1] and fasten with screws [4].
2. Clean sealing faces of cover [1] and housing.
3. Check whether O-ring [3] is in good condition, replace if damaged.
4. Apply a thin film of non-acidic grease (e.g. petroleum jelly) to the O-ring and insert it correctly.
5. Fit cover [1] and fasten screws [2] evenly crosswise.
6. Fasten cable glands [8] applying the specified torque to ensure the required enclosure protection.

## 5.3 Accessories for electrical connection

— Option —

### 5.3.1 Controls mounted to wall bracket

The wall bracket allows separate mounting of controls and actuator.

#### Application

- If the actuator cannot be accessed.
- If the actuator is subjected to high temperatures.
- In case of heavy vibration of the valve.

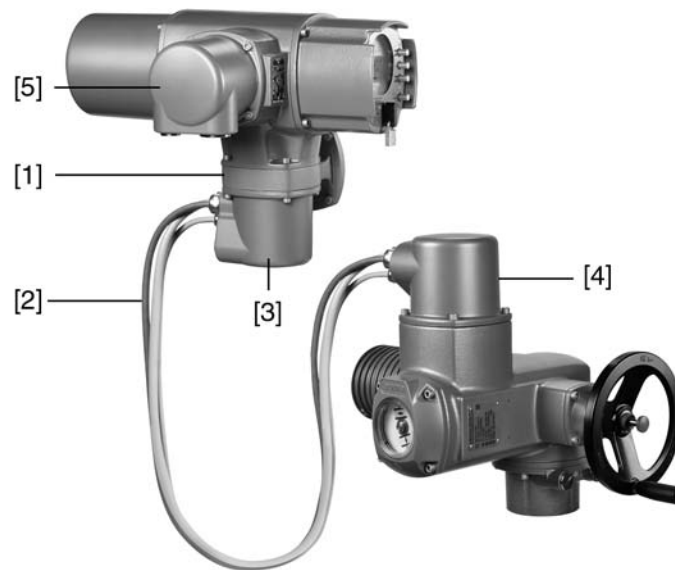
**Design** Figure 12: Design principle with wall bracket

- [1] Wall bracket
- [2] Connecting cables
- [3] Electrical connection of wall bracket (XM)
- [4] Electrical connection of actuator (XA)
- [5] Electrical connection of controls (XK) – customer connector

**Observe prior to connection**

- Permissible length of connecting cables: max. 100 m.
- We recommend: AUMA cable set LSW20.
- If the AUMA cable set is not used:
  - Use suitable flexible and screened connecting cables.
  - Use separate, CAN bus data cable for MWG of 120 Ohm character impedance (e.g. UNITRONIC BUS-FD P CAN UL/CSA - 2 x 2 x 0.5 mm<sup>2</sup>, manufacturer: Lapp).
  - Data cable connection: XM2-XA2 = CAN L, XM3-XA3 = CAN H.
  - Voltage supply MWG: XM6-XA6 = GND, XM7-XA7 = + 24 V DC (refer to wiring diagram).
  - For the electrical connection at wall bracket [3], the terminals are made as crimp connections.
  - Use a suitable four indent crimp tool for crimping.
  - Cross sections for flexible wires:
    - Control cables: max. 0.75 to 1.5 mm<sup>2</sup>
    - Mains connection: max. 2.5 to 4 mm<sup>2</sup>
- When using connecting cables, e.g. of the heater, requiring direct wiring from the actuator to the XK customer connector (XA-XM-XK, refer to wiring diagram), these connecting cables must be subject to an insulation test in compliance with EN 50178. Connecting cables for MWG do not belong to this group. They may **not** be subject to an insulation test.

**5.3.2 Parking frame**

**Application** Parking frame for safe storage of a disconnected plug.

For protection against touching the bare contacts and against environmental influences.

Figure 13: Parking frame

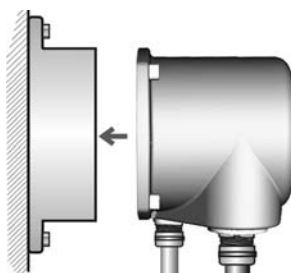

### 5.3.3 Protection cover

Protection cover for plug compartment when plug is removed.

The open terminal compartment can be closed using a protective cover (not illustrated).

### 5.3.4 Double sealed intermediate frame

When removing the electrical connection or due to leaky cable glands, ingress of dust and water into the housing may occur. This is prevented effectively by inserting the double sealed intermediate frame [2] between the plug/socket connector [1] and the housing of the device. The enclosure protection of the device (IP 68) will not be affected, even if the electrical connection [1] is removed.

Figure 14: Electrical connection with double sealed intermediate frame



[1] Electrical connection

[2] Double sealed intermediate frame

### 5.3.5 Earth connection, external

As an option, the housing is equipped with an external earth connection (U-bracket) to connect the device to the equipotential earth bonding.

Figure 15: Earth connection

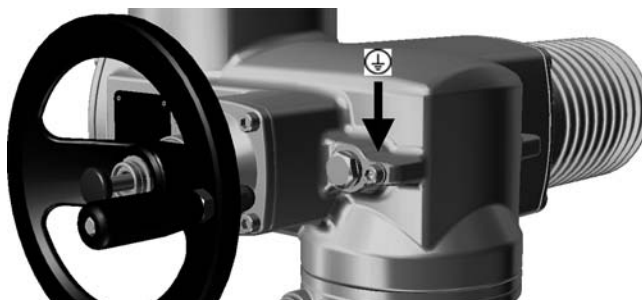

## 6. Operation

**NOTICE****Valve damage due to incorrect basic setting!**

→ Prior to electrical operation of the actuator, the basic settings i.e. type of seating, torque and limit switching have to be completed.

### 6.1 Manual operation

For purposes of setting and commissioning, in case of motor or power failure, the actuator may be operated manually. Manual operation is engaged by an internal change-over mechanism.

#### 6.1.1 Manual operation: engage

**NOTICE****Damage at the motor coupling due to faulty operation!**

→ Engage manual operation only during motor standstill.

1. Press push button.



2. Turn handwheel in desired direction.  
→ To close the valve, turn handwheel clockwise:  
    ➔ Drive shaft (valve) turns clockwise in direction CLOSE.

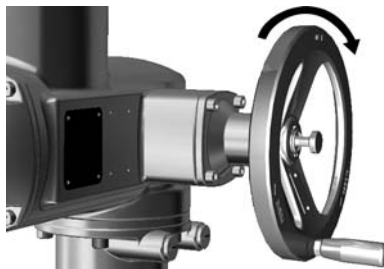

#### 6.1.2 Manual operation: disengage

Manual operation is automatically disengaged when motor is started again. The handwheel does not rotate during motor operation.

### 6.2 Motor operation

- ✓ Perform all commissioning settings and the test run prior to motor operation.

#### 6.2.1 Local actuator operation

Local actuator operation is performed using the push buttons of the local controls of the AC.

Figure 18: Local controls



- [1] Push button for operation command in direction OPEN
- [2] Push button STOP
- [3] Push button for operation command in direction CLOSE
- [4] Push button RESET
- [5] Selector switch

**CAUTION**

**Hot surfaces, e.g. possibly caused by high ambient temperatures or strong direct sunlight!**

*Danger of burns*

→ Check surface temperature and wear protective gloves, if required.

→ Set selector switch [5] to position **Local control** (LOCAL).

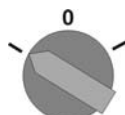

- ➔ The actuator can now be operated using the push buttons [1 – 3].
- Run actuator in direction OPEN: Press push button [1]
- Stop actuator: Press push button STOP [2].
- Run actuator in direction CLOSE: Press push button [3]

## 6.2.2 Actuator operation from remote

→ Set selector switch to position **Remote control** (REMOTE).

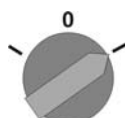

- ➔ Now, it is possible to operate the actuator via remote control, via operation commands (OPEN, STOP, CLOSE) or analogue setpoints (e.g. 0 – 20 mA).

## 6.3 Menu navigation via push buttons (for settings and indications)

Menu navigation for display and setting is made via the push buttons [1 – 4] of the local controls.

Set the selector switch [5] to position **0** (OFF) when navigating through the menu.

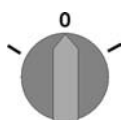

The bottom row of the display [6] serves as navigation support and explains which push buttons [1 – 4] are used for menu navigation.

Figure 22:

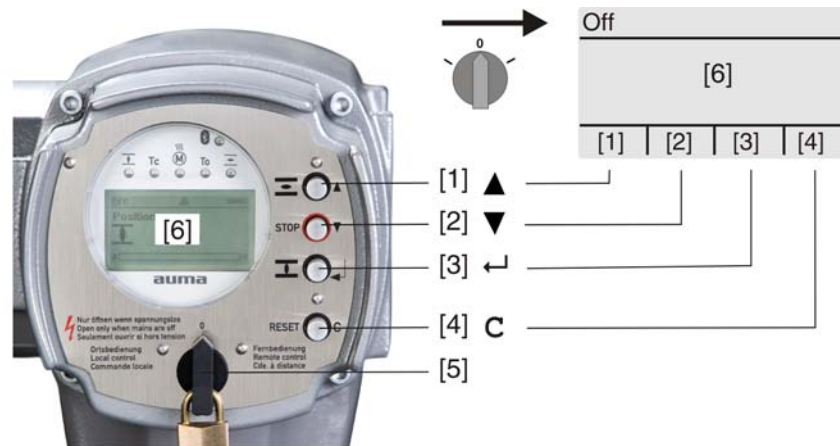

[1–4] Push buttons or navigation support

[5] Selector switch

[6] Display

Table 6: Important push button functions for menu navigation

Push buttons	Navigation support on display	Functions
[1] ▲	Up ▲	Change screen/selection
		Change values
		Enter figures from 0 to 9
[2] ▼	Down ▼	Change screen/selection
		Change values
		Enter figures from 0 to 9
[3] ↵	Ok	Confirm selection
	Save	Save
	Edit	Enter <Edit> menu
	Details	Display more details
[4] C	Setup	Enter Main menu
	Esc	Cancel process
		Return to previous display

- Backlight**
- The display is illuminated in white during normal operation. The backlight turns to red under fault conditions.
  - The screen illumination is brighter when operating a push button. If no push button is operated for 60 seconds, the display will become dim again.

### 6.3.1 Menu layout and navigation

**Groups** The indications on the display are divided into 3 groups:

Figure 23: Groups



[1] Startup menu

[2] Status menu

[3] Main menu

**ID** Status menu and main menu are marked with an ID.



Figure 24: Marking with ID

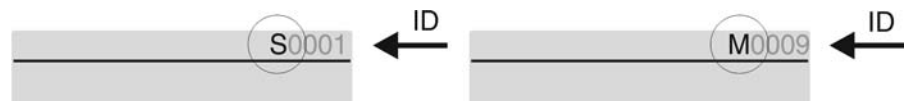

S ID starts with S = status menu

M ID starts with M = main menu

#### Group selection

It is possible to select between status menu **S** and main menu **M**:

For this, set selector switch to **0** (OFF), hold down push button **C** for approx. 2 seconds until a screen containing the ID **M...** appears.

Figure 25: Select menu groups

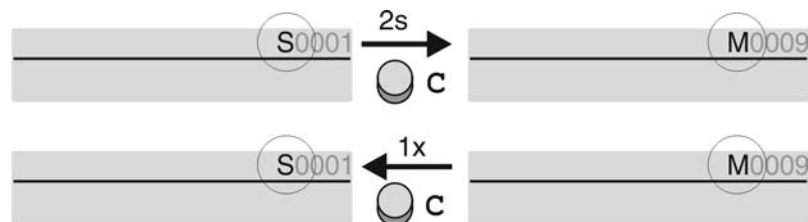

You return to the status menu if:

- the push buttons on the local controls have not been operated within 10 minutes
- or by briefly pressing **C**

#### Direct display via ID

When entering the ID within the main menu, screens can be displayed directly (without clicking through).

Figure 26: Direct display (example)

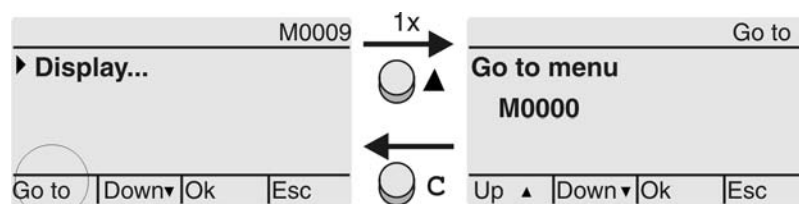

Display indicates in the bottom row: **Go to**

- Press push button **▲ Go to**.  
Display indicates: **Go to menu M0000**
- Use push buttons **▲ ▼ Up ▲ Down ▼** to select figures 0 to 9.
- Press push button **◀ Ok** to confirm first digit.
- Repeat steps 2 and 3 for all further digits.
- To cancel the process: Press **C Esc**.

## 6.4 User level, password

#### User level

The user level defines which menu items or parameters can be displayed or modified by the active user.

There are 6 different user levels. The user level is indicated in the top row:

Figure 27: User level display (example)

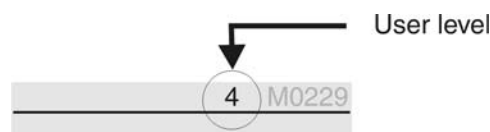

#### Password

A password must be entered to allow parameter modification. The display indicates: **Password 0\*\*\***

A specific password is assigned to each user level and permits different actions.

Table 7: User levels and authorisations

Designation (user level)	Authorisation/password
Observer (1)	Verify settings No password required
Operator (2)	Change settings Default factory password: 0000
Maintenance (3)	Reserved for future extensions
Specialist (4)	Change device configuration e.g. type of seating, assignment of output contacts Default factory password: 0000
Service (5)	Service staff Change configuration settings
AUMA (6)	AUMA administrator

#### 6.4.1 Password entry

Display indicates: Password 0\*\*\*

1. Select desired menu and hold down push button **↵** for approx. 3 seconds.  
➔ Display indicates the set user level, e.g. **Observer (1)**
2. Press **▲ Up ▲** to select a higher user level and press **↵ Ok** to confirm.  
➔ Display shows: **Password 0\*\*\***
3. Use push buttons **▲ ▼ Up ▲ Down ▼** to select figures 0 to 9.
4. Confirm first digit of password via push button **↵ Ok**.
5. Repeat steps 1 and 2 for all further digits.  
➔ Having confirmed the last digit with **↵ Ok**, access to all parameters within one user level is possible if the password entry is correct.

#### 6.4.2 Password change

Only the passwords of same or lower user level may be changed.

Example: The user is signed in as **Specialist (4)**. This authorises him or her to modify the passwords between user levels (1) to (4).

**M ▶** **Device configuration M0053**  
**Service functions M0222**  
**Change passwords M0229**

Menu point **Service functions M0222** is only visible if user level has been set to **Specialist (4)** or higher.

#### Select main menu

1. Set selector switch to position **0** (OFF).

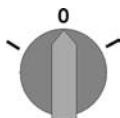

2. Press push button **C Setup** and hold it down for approx. 3 seconds.  
➔ Display goes to main menu and indicates: **▶ Display...**

## Change passwords

3. Select parameter **Change passwords** either:
  - click via the menu **M ▶** to parameter, or
  - via direct display: press **▲** and enter ID **M0229**
- Display indicates: **▶ Change passwords**
- The user level is indicated in the top row (1 – 6), e.g.:



- For user level 1 (view only), passwords cannot be changed. To change passwords, you must change to a higher user level. For this, enter a password via a parameter.
4. For a user level between 2 and 6: Press push button **↵ OK**.
  - ➔ The display indicates the highest user level, e.g.: **For user 4**
5. Select user level via push buttons **▲ ▼ Up ▲ Down ▼** and confirm with **↵ OK**.
  - ➔ Display indicates: **▶ Change passwords Password 0\*\*\***
6. Enter current password (→ enter password).
  - ➔ Display indicates: **▶ Change passwords Password (new) 0\*\*\***
7. Enter new password (→ enter password).
  - ➔ Display indicates: **▶ Change passwords For user 4 (example)**
8. Select next user level via push buttons **▲ ▼ Up ▲ Down ▼** or cancel the process via **Esc**.

## 6.5 Language in the display

The AUMATIC display is multilingual.

### 6.5.1 Language change

**M ▶** **Display...** M0009  
**Language** M0049

#### Select main menu

1. Set selector switch to position **0** (OFF).

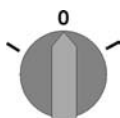

#### Change language

2. Press push button **C Setup** and hold it down for approx. 3 seconds.
  - ➔ Display goes to main menu and indicates: **▶ Display...**
3. Press **↵ OK**.
  - ➔ Display indicates: **▶ Language**
4. Press **↵ OK**.
  - ➔ Display indicates the selected language, e.g.: **▶ Deutsch**
5. The bottom row of the display indicates:
  - **Save** → continue with step 10
  - **Edit** → continue with step 6
6. Press **↵ Edit**.
  - ➔ Display indicates: **▶ Observer (1)**
7. Select user level via **▲ ▼ Up ▲ Down ▼** resulting in the following significations:
  - black triangle: **▶** = current setting
  - white triangle: **▷** = selection (not saved yet)
8. Press **↵ OK**.
  - ➔ Display indicates: **Password 0\*\*\***

**Language selection**

9. Enter password (→ enter password).
- ➡ Display indicates: ▶ **Language** and **Save** (bottom row)
10. Select new language via ▲▼ **Up** ▲ **Down** ▼ resulting in the following significations:
  - black triangle: ▶ = current setting
  - white triangle: ▷ = selection (not saved yet)
11. Confirm selection via ◀ **Save**.
- ➡ The display changes to the new language. The new language selection is saved.

7. Indications

7.1 Indications during commissioning

LED test

When switching on the power supply, all LEDs on the local controls illuminate for approx. 1 second. This optical feedback indicates that the voltage supply is connected to the controls and all LEDs are operable.

Figure 31: LED test

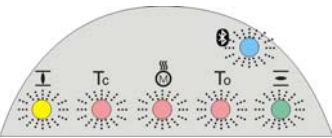

Language selection

During the self-test, the language selection can be activated so that the selected language is immediately indicated in the display. For this, set selector switch [5] to position 0 (OFF).

Activate language selection:

1.

Display indicates in the bottom row: Language selection menu? 'Reset'
2.

Press push button **RESET** and hold it down until the following text is displayed in the bottom line: Language menu loading, please wait.

Figure 32: Self-test

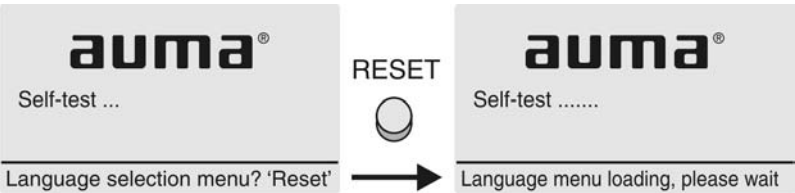

The language selection menu follows the startup menu.

Startup menu

The current firmware version is displayed during the startup procedure:

Figure 33: Startup menu with firmware version: 04.00.00–xxxx

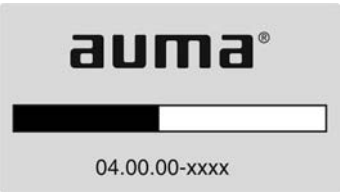

If the language selection feature has been activated during the self-test, the menu for selecting the display language will now be indicated. For further information on language setting, please refer to chapter <Language in the display>.

Figure 34: Language selection

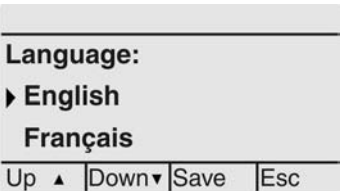

If no entry is made over a longer period of time (approx. 1 minute), the display automatically returns to the first status indication.

7.2 Indications in the display

Status bar

The status bar (first row in the display) indicates the operation mode [1], the presence of an error [2] and the ID number [3] of the current display indication.

Figure 35: Information in the status bar (top)

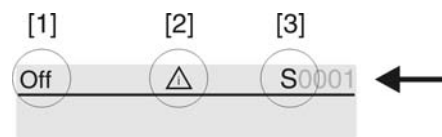

- [1] Operation mode
- [2] Error symbol (only for faults and warnings)
- [3] ID number: S = Status page

### Navigation support

If further details or information are available with reference to the display, the following indications **Details** or **More** appear in the navigation support (bottom display row). Then, further information can be displayed via the push button.

Figure 36: Navigation support (bottom)

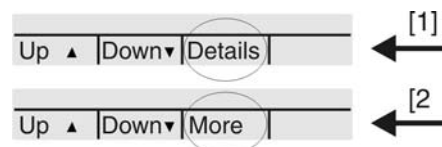

- [1] shows list with detailed indications
- [2] shows further available information

The navigation support (bottom row) is faded out after approx. 3 seconds. Press any push button (selector switch in position 0 (OFF)) to fade in the navigation support.

## 7.2.1 Feedback indications from actuator and valve

Display indications depend on the actuator version.

### Valve position (S0001)

This indication is only available if a position transmitter (potentiometer, RWG or MWG) is installed in the actuator.

- **S0001** on the display indicates the valve position in % of the travel.
- The bargraph display appears after approx. 3 seconds.
- When issuing an operation command, an arrow indicates the direction (OPEN/CLOSE).

Figure 37: Valve position and direction of operation

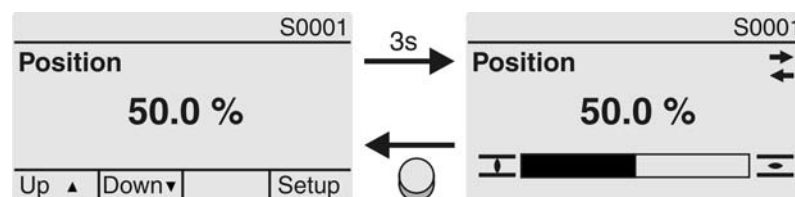

Reaching the preset end positions is additionally indicated via symbols (CLOSED) and (OPEN).

Figure 38: End position CLOSED/OPEN reached

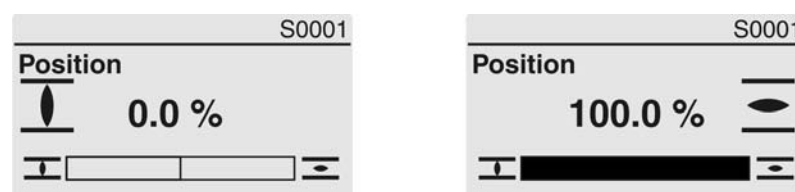

- 0% Actuator is in end position CLOSED
- 100% Actuator is in end position OPEN

### Torque (S0002)

The indication is only available if the actuator is equipped with an MWG (magnetic limit and torque transmitter).

- **S0002** on the display indicates the torque applied at the actuator output.
- The bargraph display appears after approx. 3 seconds.

Figure 39: Torque

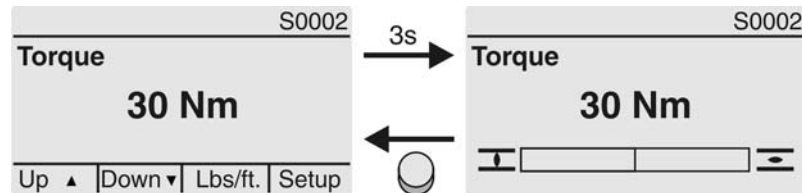

#### Select unit

The push button  allows to select the unit displayed (percent %, Newton metre Nm or pounds per foot Lbs/ft.).

Figure 40: Units of torque



#### Display in percent

100 % indication equals the max. torque indicated on the name plate of the actuator.  
Example: SA 07.5 with 20 – 60 Nm.

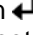
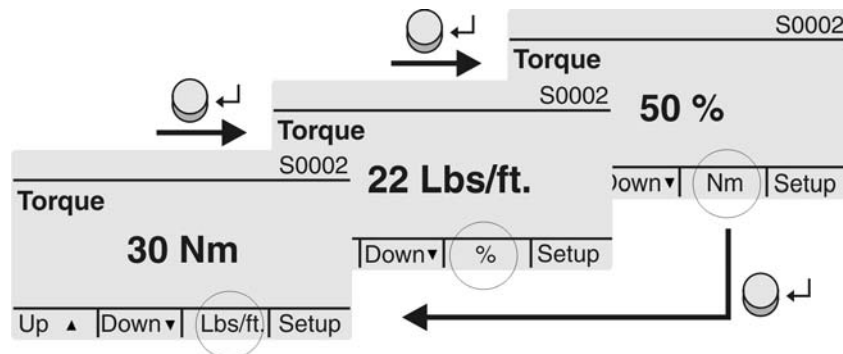
- 100 % corresponds to 60 Nm of nominal torque.
- 50 % corresponds to 30 Nm of nominal torque.

### Operation commands (S0003)

The display **S0003** indicates:

- active operation commands, like e.g.: Operation in direction CLOSE or in direction OPEN
- the actual value E2 as bargraph indication and as value between 0 and 100 %.
- for setpoint control (positioner): setpoint E1
- for stepping mode or for intermediate positions with operation profile: pivot points and operation behaviour of pivot points

The navigation support (bottom row) is faded out after approx. 3 seconds and the axis/axes for pivot point display are shown.

#### OPEN - CLOSE control

Active operation commands (OPEN, CLOSE, ...) are shown above the bargraph display. The figure below shows the operation command in direction CLOSE.

Figure 41: Display for OPEN - CLOSE control

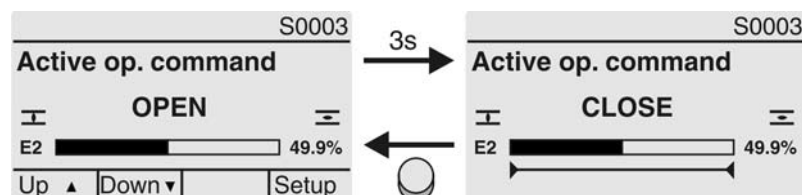

E2 Actual position value

**Setpoint control** If the positioner is enabled and activated, the bargraph indication for E1 (position setpoint) is displayed.

The direction of the operation command is displayed by an arrow above the bargraph indication. The figure below shows the operation command in direction CLOSE.

Figure 42: Display for setpoint control (positioner)

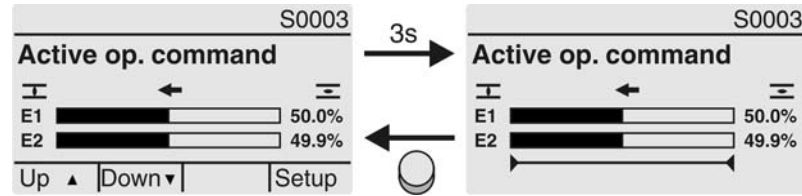

E1 Position setpoint  
E2 Actual position value

**Pivot point axis** The pivot points and their operation behaviour (operation profile) are shown on the pivot point axis by means of symbols.

The symbols are only displayed if at least one of the following functions is activated:

Operation profile M0294

Timer CLOSE M0156

Timer OPEN M0206

Figure 43: Examples: on the left pivot points (intermediate positions); on the right stepping mode



Table 8: Symbols along the pivot point axis

Symbol	Pivot point (intermediate position) with operation profile	Stepping mode
	Pivot point without reaction	End of stepping mode
◀	Stop during operation in direction CLOSE	Start of stepping mode in direction CLOSE
▶	Stop during operation in direction OPEN	Start of stepping mode in direction OPEN
◆	Stop during operation in directions OPEN and CLOSE	–
◁	Pause for operation in direction CLOSE	–
▷	Pause for operation in direction OPEN	–
◇	Pause for operation in directions OPEN and CLOSE	–

### Multiport valve positions (S0017)

In case of active multiport valve function, the display S0017 indicates a second bargraph display with set positions (valve connections) above the actual position value E2. Positions (P1, P2, ...) are displayed with a black triangle ▼. Push buttons ▲▼ are used to select positions. Both positions and the actual position value E2 are displayed in degrees.



Figure 44: Status indication for multiport valve (example P4 = 180°)

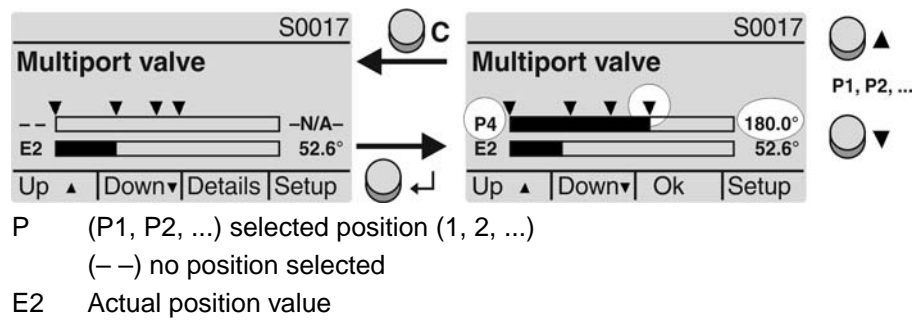

## 7.2.2 Status indications according to AUMA classification

These indications are available, if the parameter **Diagnostic classific. M0539** is set to **AUMA**.

### Warnings (S0005)

If a warning has occurred, the display shows **S0005**:

- the number of warnings occurred
- a blinking question mark after approx. 3 seconds

Figure 45: Warnings

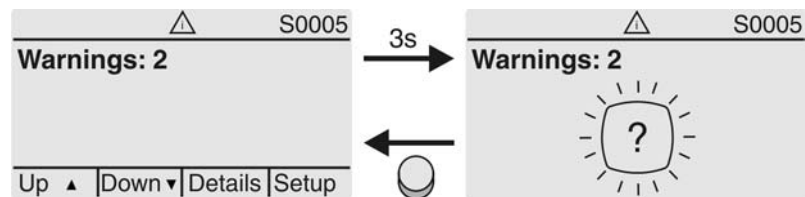

For further information, please also refer to <Corrective action>.

### Not ready REMOTE (S0006)

The **S0006** display shows indications of the Not ready REMOTE group.

If such an indication has occurred, the display shows **S0006**:

- the number of indications occurred
- a blinking crossbar after approx. 3 seconds

Figure 46: Not ready REMOTE indications

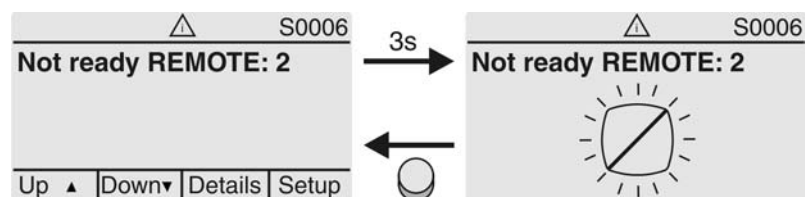

For further information, please also refer to <Corrective action>.

### Fault (S0007)

If a fault has occurred, the display shows **S0007**:

- the number of faults occurred
- a blinking exclamation mark after approx. 3 seconds

Figure 47: Fault

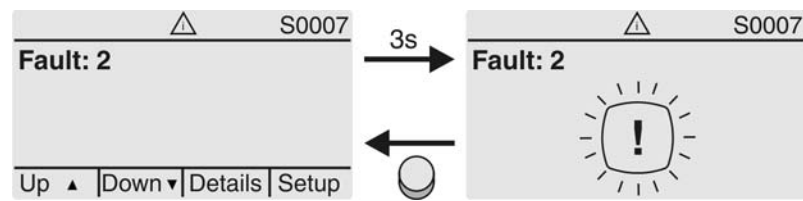

For further information, please also refer to <Corrective action>.

### 7.2.3 Status indications according to NAMUR recommendation

These indications are available, if the parameter **Diagnostic classific. M0539** is set to **NAMUR**.

#### Out of Specification (S0008)

The **S0008** indication shows out of specification indications according to NAMUR recommendation NE 107.

If such an indication has occurred, the display shows **S0008**:

- the number of indications occurred
- a blinking triangle with question mark after approx. 3 seconds

Figure 48: Out of specification

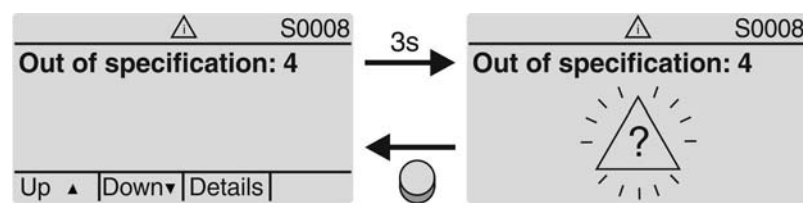

For further information, please also refer to <Corrective action>.

#### Function check (S0009)

The **S0009** indication shows function check indications according to NAMUR recommendation NE 107.

If an indication has occurred via the function check, the display shows **S0009**:

- the number of indications occurred
- a blinking triangle with a spanner after approx. 3 seconds

Figure 49: Function check

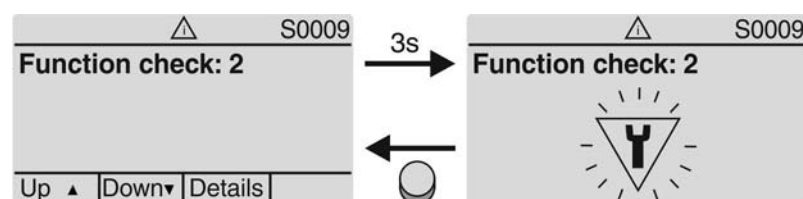

For further information, please also refer to <Corrective action>.

#### Maintenance required (S0010)

The **S0010** indication shows maintenance indications according to NAMUR recommendation NE 107.

If such an indication has occurred, the display shows **S0010**:

- the number of indications occurred
- a blinking square with an oil can after approx. 3 seconds

Figure 50: Maintenance required

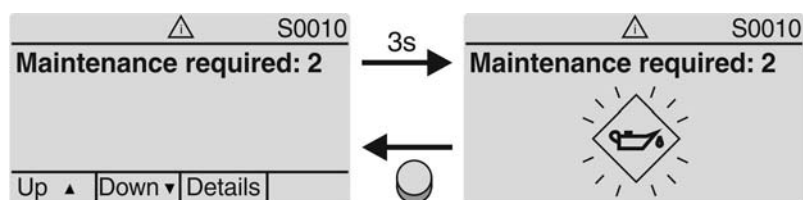

For further information, please also refer to <Corrective action>.

### Failure (S0011)

The S0011 indication shows the causes of the failure indication according to NAMUR recommendation NE 107.

If such an indication has occurred, the display shows S0011:

- the number of indications occurred
- a blinking circle with a cross after approx. 3 seconds

Figure 51: Failure

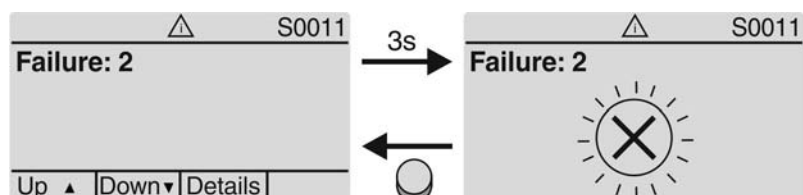

For further information, please also refer to <Corrective action>.

## 7.3 Mechanical position indicator/running indication

Mechanical position indicator:

- Continuously indicates the valve position  
(For a swing angle of 90°, the indicator disc [2] rotates by approximately 180°.)
- Indicates whether the actuator is running (running indication)
- Indicates that the end positions are reached (via indicator mark [3])

Figure 52: Mechanical position indicator



- [1] Cover
- [2] Indicator disc
- [3] Mark
- [4] Symbol for position OPEN
- [5] Symbol for position CLOSED

**7.4 Indication lights**

Figure 53: Arrangement and signification of indication lights



[1] Marking with symbols (standard)

[2] Marking with figures 1 – 6 (option)

1 End position CLOSED reached (blinking: for operation in direction CLOSE)

2 Tc Torque fault CLOSE

3 Motor protection tripped

4 To Torque fault OPEN

5 End position OPEN reached (blinking: for operation in direction OPEN)

6 Bluetooth connection

**Modify indication light assignment (indications)**

Different indications can be assigned to LEDs 1 – 5.

- M ► **Device configuration** M0053  
     **Local controls** M0159  
         Indication light 1 (left) M0093  
         Indication light 2 M0094  
         Indication light 3 M0095  
         Indication light 4 M0096  
         Indicat. light 5 (right) M0097  
         Signal interm. pos. M0167

**Default values (Europe):**

Indication light 1 (left) = End p. CLOSED, blink

Indication light 2 = Torque fault CLOSE

Indication light 3 = Thermal fault

Indication light 4 = Torque fault OPEN

Indicat. light 5 (right) = End p. OPEN, blink

Signal interm. pos. = OPEN/CLOSED = Off

## 8. Signals

### 8.1 Status signals via output contacts (digital outputs)

**Characteristics** Output contacts are used to send status signals (e.g. reaching the end positions, selector switch position, faults...) as binary signals to the control room.

Status signals only have two states: active or inactive. Active means that the conditions for the signal are fulfilled.

#### 8.1.1 Assignment of outputs

The output contacts (outputs DOUT 1 – 12) can be assigned to various signals.

Required user level: **Specialist (4)** or higher.

M ► **Device configuration** M0053  
    **I/O interface** M0139  
        **Digital outputs** M0110  
            **Signal DOUT 1** M0109

**Default values:**

**Signal DOUT 1** = **Fault**  
**Signal DOUT 2** = **End position CLOSED**  
**Signal DOUT 3** = **End position OPEN**  
**Signal DOUT 4** = **Selector sw. REMOTE**  
**Signal DOUT 5** = **Torque fault CLOSE**  
**Signal DOUT 6** = **Torque fault OPEN**  
**Signal DOUT 7** = **End position CLOSED**  
**Signal DOUT 8** = **End position OPEN**  
**Signal DOUT 9** = **Selector sw. REMOTE**  
**Signal DOUT 10** = **Torque fault CLOSE**  
**Signal DOUT 11** = **Torque fault OPEN**  
**Signal DOUT 12** = **Fault**

#### 8.1.2 Encoding of outputs

The output signals DOUT 1 – 12 can be set either to high active or low active.

- High active = output contact closed = signal active
- Low active = output contact open = signal active

Required user level: **Specialist (4)** or higher.

M ► **Device configuration** M0053  
    **I/O interface** M0139  
        **Digital outputs** M0110  
            **Coding DOUT 1** M0102

**Default values for DOUT 1 – 12:** **High active**

### 8.2 Analogue signals

**Valve position** Signal: E2 = 0/4 – 20 mA (galvanically isolated)

Designation in the wiring diagram:

ANOUT1 (position)

**Torque feedback** Signal: E6 = 0/4 – 20 mA (galvanically isolated)

Designation in the wiring diagram:

ANOUT2 (torque)

For further information on this topic, please refer to Manual (Operation and setting).

## 9. Commissioning (basic settings)

1. Set selector switch to position **0** (OFF).

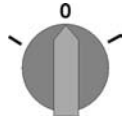

**Information:** The selector switch is not a mains switch. When positioned to **0** (OFF), the actuator cannot be operated. The controls' power supply is maintained.

2. Switch on the power supply.

**Information:** Please consider the heat-up time for ambient temperatures below  $-20\text{ }^{\circ}\text{C}$ .

3. Perform basic settings.

### 9.1 End stops in part-turn actuator

The internal end stops limit the swing angle. They protect the valve in the event of limit switching failure.

End stop setting is generally performed by the valve manufacturer **prior** to installing the valve into the pipework.



#### Exposed, rotating parts (discs/balls) at the valve!

*Pinching and damage by valve or actuator.*

- End stops should be set by suitably qualified personnel only.
- Never completely remove the setting screws [2] and [4] to avoid oil leakage.
- Observe dimension  $T_{\min}$ .

#### Information

- The swing angle set in the factory is indicated on the name plate:



- The setting sequence depends on the valve:
  - Recommendation for **butterfly valves**: Set end stop CLOSED first.
  - Recommendation for **ball valves**: Set end stop OPEN first.

Figure 56: End stop

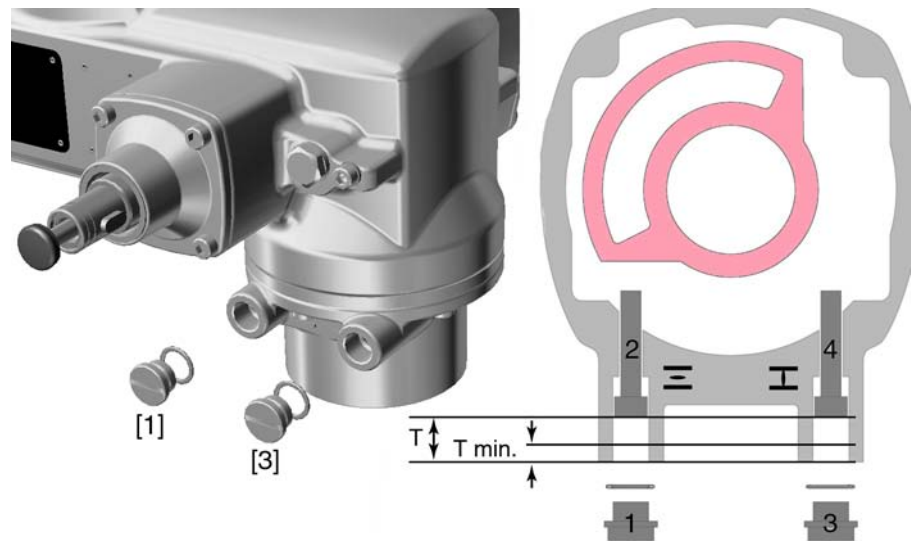

- [1] Screw plug for end stop OPEN
- [2] Setting screw for end stop OPEN
- [3] Screw plug for end stop CLOSED
- [4] Setting screw for end stop CLOSED

Dimensions/sizes	05.2	07.2	10.2	12.2	14.2
T (for 90°)	17	17	20	23	23
T <sub>min.</sub>	11	11	12	13	12

### 9.1.1 End stop CLOSED: set

1. Remove screw plug [3].
2. Move valve to end position CLOSED with handwheel.
3. If the valve end position is not reached:
  - Slightly turn setting screw [4] counterclockwise until valve end position CLOSED can be safely set.
    - ➔ Turning the setting screw [4] clockwise results in a smaller swing angle.
    - ➔ Turning the setting screw [4] counterclockwise results in a larger swing angle.



4. Turn setting screw [4] clockwise to the stop.
  - ➔ This completes the setting of end stop CLOSED.
5. Check O-ring in screw plug and replace if damaged.
6. Fasten and tighten screw plug [3].

Having completed this procedure, the end position detection CLOSED can be set immediately.

### 9.1.2 End stop OPEN: set

**Information** In general, the end stop OPEN does not have to be set.

1. Remove screw plug [1].
2. Move valve to end position OPEN with handwheel.

3. If the valve end position is not reached:
  - Slightly turn setting screw [2] counterclockwise until valve end position OPEN can be safely set.
    - ➔ Turning the setting screw [2] clockwise results in a smaller swing angle.
    - ➔ Turning the setting screw [2] counterclockwise results in a larger swing angle.



4. Turn setting screw [2] clockwise to the stop.
    - ➔ This completes the setting of end stop OPEN.
  5. Check O-ring in screw plug and replace if damaged.
  6. Fasten and tighten screw plug [1].
- Having completed this procedure, the end position detection OPEN can be set immediately.

## 9.2 Type of seating: set

### NOTICE

#### Valve damage due to incorrect setting!

- The type of seating must suit the valve.
- Only change the setting with the consent of the valve manufacturer.

- M ▶ Customer settings M0041  
 Type of seating M0012  
 End position CLOSED M0086  
 End position OPEN M0087

Default value: Limit

#### Setting values:

Limit Seating in end positions via limit switching.

Torque Seating in end positions via torque switching.

#### Select main menu

1. Set selector switch to position 0 (OFF).

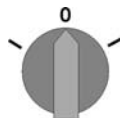

2. Press push button C Setup and hold it down for approx. 3 seconds.
  - ➔ Display goes to main menu and indicates: ▶ Display...

#### Select parameter

3. Select parameter either:
  - click via the menu M ▶ to parameter, or
  - via direct display: press ▲ and enter ID M0086 or M0087
- ➔ Display indicates: End position CLOSED

#### CLOSE or OPEN

4. Use ▲▼ Up ▲ Down ▼ to select:
  - ▶ End position CLOSED
  - ▶ End position OPEN
- ➔ The black triangle ▶ indicates the current selection.



- Log on user**
5. Press **↵** **Ok**.
  - ➔ Display indicates the current setting: **Limit** or **Torque**
  - ➔ The bottom row of the display indicates either:
    - **Edit** → continue with step 6
    - **Save** → continue with step 10
  6. Press **↵** **Edit**.
  - ➔ Display indicates: ▶ **Specialist (4)**
  7. Use **▲▼** **Up** **▲** **Down** **▼** to select user:  
**Information:** Required user level: **Specialist (4)** or higher
  - ➔ The symbols have the following meaning:
    - black triangle: ▶ = current setting
    - white triangle: ▷ = selection (not saved yet)
  8. Press **↵** **Ok**.
  - ➔ Display indicates: **Password 0\*\*\***
  9. Enter password (→ enter password).
  - ➔ The screen indicates the pre-set type of seating (▶ **Limit** or ▶ **Torque**) by means of a black triangle ▶.
- Change settings**
10. Select new setting **▲▼** **Up** **▲** **Down** **▼** resulting in the following significations:
    - ➔ The symbols have the following meaning:
      - black triangle: ▶ = current setting
      - white triangle: ▷ = selection (not saved yet)
  11. Confirm selection via **↵** **Save**.
  - ➔ The setting for the type of seating is complete.
  12. Back to step 4 (CLOSED or OPEN): Press **↵** **Esc**.

### 9.3 Torque switching: set

Once the set torque is reached, the torque switches will be tripped (overload protection of the valve).

**Information** The torque switches may also trip during manual operation.

#### NOTICE

#### Valve damage due to excessive tripping torque limit setting!

- The tripping torque must suit the valve.
- Only change the setting with the consent of the valve manufacturer.

**M ▶** **Customer settings** **M0041**  
**Torque switching** **M0013**  
**Trip torque CLOSE** **M0088**  
**Trip torque OPEN** **M0089**

**Default value:** According to order data

**Setting range:** Torque range according to actuator name plate

- Select main menu**
1. Set selector switch to position **0** (OFF).

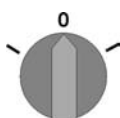

2. Press push button **C** **Setup** and hold it down for approx. 3 seconds.
- ➔ Display goes to main menu and indicates: ▶ **Display...**

- |                         |   |
|-------------------------|---|
| <b>Select parameter</b> | 3. Select parameter either:<br>→ click via the menu <b>M ▶</b> to parameter, or<br>→ via direct display: press <b>▲</b> and enter ID <b>M0088</b> .<br>↳ Display indicates: <b>Trip torque CLOSE</b>  |
| <b>CLOSE or OPEN</b>    | 4. Select via <b>▲ ▼ Up ▲ Down ▼</b> :<br>→ ▶ <b>Trip torque CLOSE</b><br>→ ▶ <b>Trip torque OPEN</b><br>↳ The black triangle ▶ indicates the current selection.<br>5. Press <b>↵ Ok</b> .<br>↳ Display shows the set value.<br>↳ The bottom row indicates: <b>Edit Esc</b><br>6. Press <b>↵ Edit</b> .<br>↳ Display indicates:<br>- <b>Specialist (4)</b> → continue with step 7<br>- in bottom row <b>Up ▲ Down ▼ Esc</b> → continue with step 11   |
| <b>Log on user</b>      | 7. Use <b>▲ ▼ Up ▲ Down ▼</b> to select user:<br><b>Information:</b> Required user level: <b>Specialist (4)</b> or higher<br>↳ The symbols have the following meanings:<br>- black triangle: ▶ = current setting<br>- white triangle: ▷ = selection (not saved yet)<br>8. Press <b>↵ Ok</b> .<br>↳ Display indicates: <b>Password 0***</b><br>9. Enter password (→ enter password).<br>↳ Display shows the set value.<br>↳ The bottom row indicates: <b>Edit Esc</b><br>10. Press <b>↵ Edit</b> .   |
| <b>Change value</b>     | 11. Enter new value for tripping torque via <b>▲ ▼ Up ▲ Down ▼</b> .<br><b>Information:</b> The adjustable torque range is shown in round brackets<br>12. Save new value via <b>↵ Save</b> .<br>↳ The tripping torque is set.<br>13. Back to step 4 (CLOSED or OPEN): Press <b>↵ Esc</b> .  |
| <b>Information</b>      | The following fault signals are sent if the set torque is reached <b>in mid-travel</b> : <ul style="list-style-type: none"> <li>• Status indication <b>S0007 Fault = Torque fault OPEN</b> or <b>Torque fault CLOSE</b></li> </ul> The fault has to be acknowledged before the operation can be resumed. The acknowledgement is made: <ol style="list-style-type: none"> <li>1. either by an operation command in the opposite direction.             <ul style="list-style-type: none"> <li>- For <b>Torque fault OPEN</b>: Operation command in direction OPEN</li> <li>- For <b>Torque fault CLOSE</b>: Operation command in direction CLOSE</li> </ul> </li> <li>2. or, in case the torque applied is lower than the preset tripping torque:             <ul style="list-style-type: none"> <li>- via the push button <b>RESET</b> in selector switch position <b>Local control</b> (LOCAL).</li> </ul> </li> </ol> |

## 9.4 Limit switching: set

### NOTICE

#### Valve damage at valve/gearbox due to incorrect setting!

- When setting with motor operation: Stop actuator **before** reaching end of travel (press push button **STOP**).
- Allow for overrun when selecting limit seating.

#### M ▶

Customer settings M0041  
Limit switching M0010  
Set end pos.CLOSED? M0084  
Set end pos. OPEN? M0085

#### Select main menu

1. Set selector switch to position **0** (OFF).

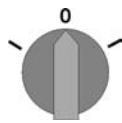

2. Press push button **C** and hold it down for approx. 3 seconds.
- Display goes to main menu and indicates: ▶ Display...

#### Select parameter

3. Select parameter either:
  - click via the menu **M ▶** to parameter, or
  - via direct display: press **▲** and enter ID **M0084**.

→ Display indicates: Set end pos.CLOSED?

#### CLOSED or OPEN

4. Use **▲▼ Up ▲ Down ▼** to select:
  - ▶ Set end pos.CLOSED? M0084
  - ▶ Set end pos. OPEN? M0085

→ The black triangle ▶ indicates the current selection.

5. Press **↵ Ok**.

→ The display indicates either:

- Set end pos.CLOSED? CMD0009 → continue with step 9
- Set end pos. OPEN? CMD0010 → continue with step 14
- Specialist (4) → continue with step 6

#### Log on user

6. Use **▲▼ Up ▲ Down ▼** to select a user:  
**Information:** Required user level: **Specialist (4)** or higher

→ The symbols have the following meaning:

- black triangle: ▶ = current setting
- white triangle: ▷ = selection (not saved yet)

7. Press **↵ Ok** to confirm selected user level.

→ Display indicates: Password 0\*\*\*

8. Enter password (→ enter password).

→ The display indicates either:

- Set end pos.CLOSED? CMD0009 → continue with step 9
- Set end pos. OPEN? CMD0010 → continue with step 14

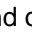
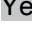

**Set end position CLOSED**  
CMD0009

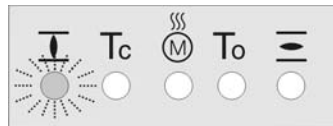
9. Re-set end position CLOSED:
  - 9.1 For large strokes: Set selector switch in position **Local control** (LOCAL) and operate actuator in motor operation via push button  (CLOSED) in direction of the end position.  
**Information:** Stop actuator **before** reaching end of travel (press push button **STOP**) to avoid damage.
  - 9.2 Engage manual operation.
  - 9.3 Turn handwheel until valve is closed.
  - 9.4 Set selector switch to position **0** (OFF).
    - ➔ Display indicates: **Set end pos.CLOSED? Yes No**
10. Press  **Yes** to accept new end position setting.
  - ➔ Display indicates: **End pos. CLOSED set!**
  - ➔ The left LED is illuminated (standard version) and thus indicates that the end position CLOSED setting is complete.

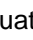

11. Make selection:
  - ➔ **Edit** → back to step 9: Set end position CLOSED "once again"
  - ➔ **Esc** → back to step 4; either set end position OPEN or exit the menu.

**Set end position OPEN**  
CMD0010

12. Re-set end position OPEN:
  - 12.1 For large strokes: Set selector switch in position **Local control** (LOCAL) and operate actuator in motor operation via push button  (OPEN) in direction of the end position.  
**Information:** Stop actuator **before** reaching end of travel (press push button **STOP**) to avoid damage.
  - 12.2 Engage manual operation.
  - 12.3 Turn handwheel until valve is open.
  - 12.4 Set selector switch to position **0** (OFF).
    - ➔ Display indicates: **Set end pos. OPEN? Yes No**
13. Press  **Yes** to accept new end position setting.
  - ➔ Display indicates: **End pos. OPEN set!**
  - ➔ The right LED is illuminated (standard version) and thus indicates that the end position setting is complete.

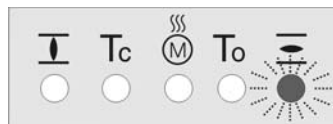

14. Make selection:
  - ➔ **Edit** → back to step 9: Set end position OPEN "once again"
  - ➔ **Esc** → back to step 4; either set end position CLOSED or exit the menu.

**Information** If an end position cannot be set: Check the type of control unit in actuator.

**9.5 Test run**

Perform test run only once all settings previously described have been performed.

### 9.5.1 Direction of rotation: check

1. Move actuator manually to intermediate position or to sufficient distance from end position.
  2. Switch on actuator in direction CLOSE and observe the direction of rotation on the indicator disc.
    - Switch off before reaching the end position.
- ➔ The direction of rotation is correct if **actuator runs in direction CLOSE** and **indicator disc turns counterclockwise**.



### 9.5.2 Limit switching: check

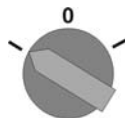

1. Set selector switch to position **Local control** (LOCAL).



2. Operate actuator using push buttons OPEN - STOP - CLOSE.
  - ➔ The limit switching is set correctly if (default indication):
    - the yellow indication light/LED1 is illuminated in end position CLOSED
    - the green indication light/LED5 is illuminated in end position OPEN
    - the indication lights go out after travelling into opposite direction.
  - ➔ The limit switching is set incorrectly if:
    - the actuator comes to a standstill before reaching the end position
    - one of the red indication lights/LEDs is illuminated (torque fault)
    - the status indication **S0007** in the display signals a fault.
3. If the end position setting is incorrect: Reset limit switching.

### 9.6 Mechanical position indicator: set

— Option —

1. Move valve to end position CLOSED.
2. Turn lower indicator disc until symbol  (CLOSED) is in alignment with the mark  on the cover.



3. Move actuator to end position OPEN.

4. Hold lower indicator disc in position and turn upper disc with symbol  (OPEN) until it is in alignment with the mark ▲ on the cover.



5. Move valve to end position CLOSED again.
6. Check settings:  
If the symbol  (CLOSED) is no longer in alignment with mark ▲ on the cover:  
→ Repeat setting procedure.

## 9.7 Switch compartment: close

### NOTICE

#### **Danger of corrosion due to damage to paint finish!**

→ Touch up damage to paint finish after work on the device.

1. Clean sealing faces of housing and cover.
2. Check whether O-ring [3] is in good condition, replace if damaged.
3. Apply a thin film of non-acidic grease (e.g. petroleum jelly) to the O-ring and insert it correctly.

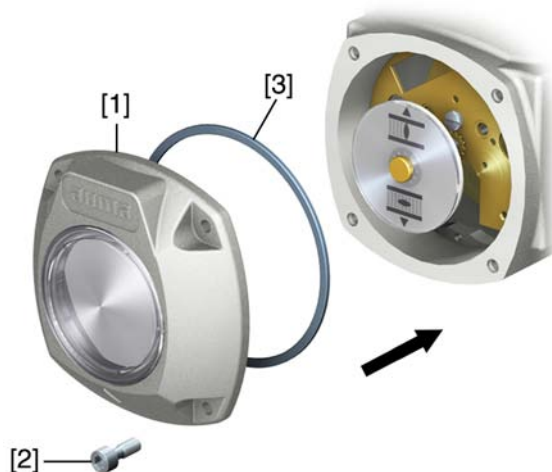

4. Place cover [1] on switch compartment.
5. Fasten screws [2] evenly crosswise.

## 10. Corrective action

### 10.1 Faults during commissioning

Table 9: Faults during commissioning

Fault description	Possible causes	Remedy
Mechanical position indicator cannot be set.	Reduction gearing is not suitable for turns/stroke of the actuator.	Set gear stage of the reduction gearing. The control unit might have to be exchanged.
Fault in end position Actuator runs to end stop although the limit switches work properly.	The overrun was not considered when setting the limit switching. The overrun is generated by the inertia of both the actuator and the valve and the delay time of the controls.	Determine overrun: Overrun = travel covered from switching off until complete standstill. Set limit switching again considering the overrun (turn handwheel back by the amount of the overrun).

### 10.2 Fault indications and warning indications

**Faults** interrupt or prevent the electrical actuator operation. In the event of a fault, the display backlight is red.

**Warnings** have no influence on the electrical actuator operation. They only serve for information purposes.

**Collective signals** include further indications which can be displayed via the  **Details** push button.

Table 10: Faults and warnings via status indications in the display

Indication on display	Description/cause	For indicated value > 0:
Warnings S0005	Collective signal 02: Indicates the number of active warnings.	Press push button  <b>Details</b> . For details, refer to <Warnings and Out of specification> table.
Not ready REMOTE S0006	Collective signal 04: Indicates the number of active signals.	Press push button  <b>Details</b> . For details, refer to <Not ready REMOTE and Function check> table.
Fault S0007	Collective signal 03: Indicates the number of active faults. The actuator cannot be operated.	Press push button  <b>Details</b> to display a list of detailed indications. For details, refer to <Faults and Failure> table.
Out of specification S0008	Collective signal 07: Indication according to NAMUR recommendation NE 107 Actuator is operated outside the normal operation conditions.	Press push button  <b>Details</b> . For details refer to <Warnings and Out of specification> table.
Function check S0009	Collective signal 08: Indication according to NAMUR recommendation NE 107 The actuator is being worked on; output signals are temporarily invalid.	Press push button  <b>Details</b> . For details, refer to <Not ready REMOTE and Function check> table.
Maintenance required S0010	Collective signal 09: Indication according to NAMUR recommendation NE 107 Recommendation to perform maintenance.	Press push button  <b>Details</b> to display a list of detailed indications.
Failure S0011	Collective signal 10: Indication according to NAMUR recommendation NE 107 Actuator function failure, output signals are invalid	Press push button  <b>Details</b> to display a list of detailed indications. For details, refer to <Faults and Failure> table.



Table 11: Warnings and Out of specification

Indication on display	Description/cause	Remedy
Config. warning	Collective signal 06: Possible cause: Configuration setting is incorrect. The device can still be operated with restrictions.	Press push button  Details to display a list of individual indications.
Internal warning	Collective signal 15: Device warnings The device can still be operated with restrictions.	Press push button  Details to display a list of individual indications.
24 V DC external	The external 24 V DC voltage supply of the controls has exceeded the power supply limits.	Check 24 V DC voltage supply.
Wrn on time running	Warning on time max. running time/h exceeded	<ul style="list-style-type: none"> <li>Check modulating behaviour of actuator.</li> <li>Check parameter <b>Perm. running time/h M0356</b>, re-set if required.</li> </ul>
Wrn on time starts	Warning on time max. number of motor starts (starts) exceeded	<ul style="list-style-type: none"> <li>Check modulating behaviour of actuator.</li> <li>Check parameter <b>Permissible starts/h M0357</b>, re-set if required.</li> </ul>
Failure behav. active	The failure behaviour is active since all required setpoints and actual values are incorrect.	Verify signals: <ul style="list-style-type: none"> <li>Setpoint E1</li> <li>Actual value E2</li> <li>Actual process value E4</li> </ul>
Wrn input AIN 1	Warning: Loss of signal analogue input 1	Check wiring.
Wrn input AIN 2	Warning: Loss of signal analogue input 2	Check wiring.
Wrn setpoint position	Warning: Loss of signal of actuator setpoint position Possible causes: Input signal for setpoint = 0 (signal loss)	Check setpoint signal.
Op. time warning	The set time (parameter <b>Perm.op. time, manual M0570</b> ) has been exceeded. The preset operating time is exceeded for a complete travel from end position OPEN to end position CLOSED.	The warning indications are automatically cleared once a new operation command is executed. <ul style="list-style-type: none"> <li>Check valve.</li> <li>Check parameter <b>Perm.op. time, manual M0570</b>.</li> </ul>
Wrn controls temp.	Temperature within controls housing too high	Measure/reduce ambient temperature.
Wrn motor temp.	Temperature within motor winding too high	Check actuator sizing, correct accordingly.
Wrn gearbox temp.	Temperature within actuator gear housing too high	Check actuator sizing, correct accordingly.
RTC not set	Real time clock has not yet been set.	Set time.
RTC button cell	Voltage of the RTC button cell is too low.	Replace button cell.
PVST fault	Partial Valve Stroke Test (PVST) could not be successfully completed.	Check actuator (PVST settings).
PVST abort	Partial Valve Stroke Test (PVST) was aborted or could not be started.	Perform RESET or restart PVST.
Wrn no reaction	No actuator reaction to operation commands within the set reaction time.	<ul style="list-style-type: none"> <li>Check movement at actuator.</li> <li>Check parameter <b>Reaction time M0634</b>.</li> </ul>
Wrn FOC	Optical receiving signal (channel 1) incorrect (no or insufficient Rx receive level) or RS-485 format error (incorrect bit(s))	Check/repair FO cables.
Wrn FO cable budget	Warning: FO cable system reserve reached (critical or permissible Rx receive level)	Check/repair FO cables.
Wrn FOC connection	Warning FO cable connection is not available.	Fit FO cable connection.
Torque wrn OPEN	Limit value for torque warning in direction OPEN exceeded.	Check parameter <b>Wrn torque OPEN M0768</b> , re-set if required.
Torque wrn CLOSE	Limit value for torque warning in direction CLOSE exceeded.	Check parameter <b>Wrn torque CLOSE M0769</b> , re-set if required.

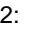
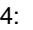
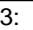
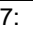
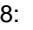
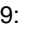
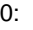

Table 12: Faults and Failure



Indication on display	Description/cause	Remedy
Configuration error	Collective signal 11: Configuration error has occurred.	Press push button  <b>Details</b> to display a list of individual indications.
Config. error REMOTE	Collective signal 22: Configuration error has occurred.	Press push button  <b>Details</b> to display a list of individual indications.
Internal error	Collective signal 14: Internal error has occurred.	AUMA service Press push button  <b>Details</b> to display a list of individual indications.
Torque fault CLOSE	Torque fault in direction CLOSE	Perform one of the following measures: <ul style="list-style-type: none"> <li>• Issue operation command in direction OPEN.</li> <li>• Set selector switch to position <b>Local control</b> (LOCAL) and reset fault indication via push button <b>RESET</b>.</li> </ul>
Torque fault OPEN	Torque fault in direction OPEN	Perform one of the following measures: <ul style="list-style-type: none"> <li>• Issue operation command in direction CLOSE.</li> <li>• Set selector switch to position <b>Local control</b> (LOCAL) and reset fault indication via push button <b>RESET</b>.</li> </ul>
Phase fault	<ul style="list-style-type: none"> <li>• When connecting to a 3-ph AC system and with internal 24 V DC supply of the electronics: Phase 2 is missing.</li> <li>• When connecting to a 3-ph or 1-ph AC system and with external 24 V DC supply of the electronics: One of the phases L1, L2 or L3 is missing.</li> </ul>	Test/connect phases.
Incorrect phase seq	The phase conductors L1, L2 and L3 are connected in the wrong sequence. Only applicable if connected to a 3-ph AC system.	Correct the sequence of the phase conductors L1, L2 and L3 by exchanging two phases.
Mains quality	Due to insufficient mains quality, the controls cannot detect the phase sequence (sequence of phase conductors L1, L2 and L3) within the pre-set time frame provided for monitoring.	<ul style="list-style-type: none"> <li>• Check mains voltage.</li> <li>• Check parameter <b>Tripping time M0172</b>, extend time frame if required.</li> </ul>
Thermal fault	Motor protection tripped	<ul style="list-style-type: none"> <li>• Cool down, wait.</li> <li>• If the fault indication display persists after cooling down: <ul style="list-style-type: none"> <li>- Set selector switch to position <b>Local control</b> (LOCAL) and reset fault indication via push button <b>RESET</b>.</li> </ul> </li> <li>• Check fuses.</li> </ul>
Fault no reaction	No actuator reaction to operation commands within the set reaction time.	Check movement at actuator.

Table 13: Not ready REMOTE and Function check (collective signal 04)

Indication on display	Description/cause	Remedy
Wrong oper. cmd	Collective signal 13: Possible causes: <ul style="list-style-type: none"> <li>Several operation commands (e.g. OPEN and CLOSE simultaneously, or OPEN and SETPOINT operation simultaneously)</li> <li>A setpoint is present and the positioner is not active</li> <li>For fieldbus: Setpoint exceeds 100.0 %</li> </ul>	<ul style="list-style-type: none"> <li>Check operation commands (send one operation command only).</li> <li>Set parameter <b>Positioner</b> to <b>Function active</b>.</li> <li>Check setpoint.</li> </ul> Press push button <b>Details</b> to display a list of individual indications.
Sel. sw. not REMOTE	Selector switch is not in position REMOTE.	Set selector switch to position REMOTE.
Service active	Operation via service interface (Bluetooth) and service software AUMA CDT.	Exit service software.
Disabled	Actuator is in operation mode Disabled.	Check setting and status of function <Local controls enable>.
EMCY stop active	The EMERGENCY stop switch has been operated. The motor control power supply (contactors or thyristors) is disconnected.	<ul style="list-style-type: none"> <li>Enable EMERGENCY stop switch.</li> <li>Reset EMERGENCY stop state by means of Reset command.</li> </ul>
EMCY behav. active	Operation mode EMERGENCY is active (EMERGENCY signal was sent). 0 V are applied at the EMERGENCY input.	<ul style="list-style-type: none"> <li>Detect cause for EMERGENCY signal.</li> <li>Verify failure source.</li> <li>Apply +24 V DC at EMERGENCY input.</li> </ul>
I/O interface	The actuator is controlled via the I/O interface (parallel).	Check I/O interface.
Handwheel active	Manual operation is activated.	Start motor operation.
FailState fieldbus	Fieldbus connection available, however no process data transmission by the master.	Verify master configuration
Local STOP	A local STOP is active. Push button STOP of local controls is operated.	Release push button STOP.
Interlock	An interlock is active.	Check interlock signal.
Interlock by-pass	By-pass function is interlocked.	Check states of main and by-pass valve.
PVST active	Partial Valve Stroke Test (PVST) is active.	Wait until PVST function is complete.

## 10.3 Fuses

### 10.3.1 Fuses within the actuator controls

#### Fuses used

#### F1/F2 Primary fuses on power supply unit

G fuse	F1/F2	AUMA art. no.
Size	6.3 x 32 mm	
Reversing contactors Power supply ≤ 500 V	1 A T; 500 V	K002.277
Reversing contactors Power supply > 500 V	2 A FF; 690 V	K002.665
Thyristor units for motor power up to 1.5 kW	1 A T; 500 V	K002.277
Thyristor units for motor power up to 3.0 kW		
Thyristor units for motor power up to 5.5 kW		

#### F3 Internal 24 V DC supply

G fuse according to IEC 60127-2/III	F3	AUMA art. no.
Size	5 x 20 mm	
Voltage output (power supply unit) = 24 V	2.0 A T; 250 V	K006.106
Voltage output (power supply unit) = 115 V	2.0 A T; 250 V	K006.106

#### F4 Internal 24 V AC supply (115 V AC) for:

- Heater, switch compartment, reversing contactors control
- PTC tripping device
- for 115 V AC also control inputs OPEN - STOP - CLOSE

G-fuse according to IEC 60127-2/III	F4	AUMA art. no.
Size	5 x 20 mm	
Voltage output (power supply unit) = 24 V	1.25 A T; 250 V	K001.184
Voltage output (power supply unit) = 115 V	—	—

**F5** Automatic reset fuse as short-circuit protection for external 24 V DC supply for customer (see wiring diagram)

Replace fuses F1/F2



Hazardous voltage!

Risk of electric shock.

→ Disconnect device from the mains before opening.

1. Loosen screws [1] and remove plug/socket connector [2].

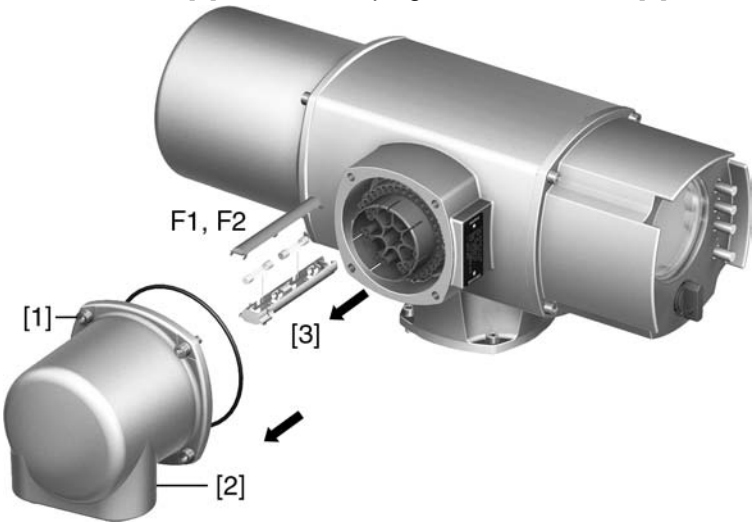

2. Pull fuse holder [3] out of pin carrier, open fuse cover and replace old fuses by new ones.

**Fuses F3/F4: test/replace**

1. Loosen screws [1] and remove cover [2] on the rear of the actuator controls.

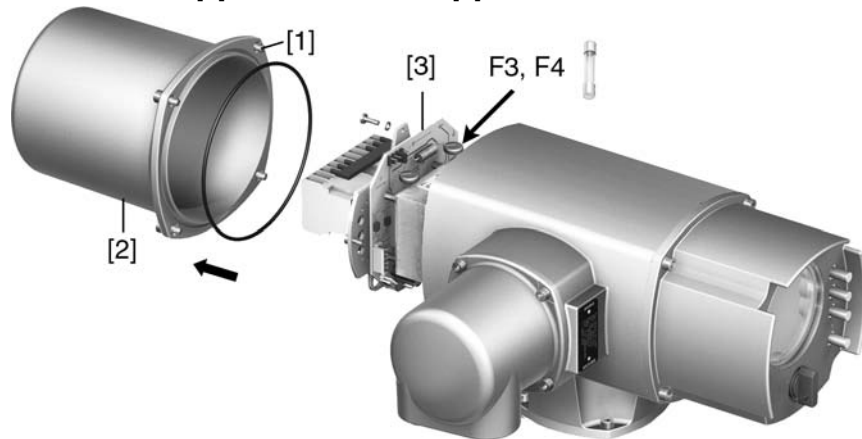

The power supply unit has measurement points (solder pins) allowing to perform a resistance (continuity) measurement:

Verifying	Measuring points
F3	MTP5 – MTP6
F4	MTP7 – MTP8

2. To replace defective fuses: Carefully loosen power supply unit [3] and pull out. (The fuses are on the equipped part of the power supply board).

**NOTICE****Cable damage due to pinching!**

*Risk of functional failures.*

→ Carefully assemble power supply unit to avoid pinching the cables.

**10.3.2 Motor protection (thermal monitoring)**

In order to protect against overheating and impermissibly high surface temperatures at the actuator, PTC thermistors or thermostats are embedded in the motor winding. The thermostat is tripped as soon as the max. permissible winding temperature has been reached.

The actuator is switched off and the following signals are given:

- LED 3 (thermal fault) on the local controls is illuminated.
- Status indication **S0007** displays a fault. The fault **Thermostat** is displayed when selecting **Details**.

The motor has to cool down before the operation can be resumed. Depending on the parameter setting, the fault signal is either automatically reset or the fault signal has to be reset using the push button **Reset** in selector switch position LOCAL.

For further information to this topic, please refer to Manual (Operation and setting).

## 11. Servicing and maintenance

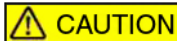

### Damage caused by inappropriate maintenance!

- Servicing and maintenance must be carried out exclusively by suitably qualified personnel having been authorised by the end user or the contractor of the plant. Therefore, we recommend contacting our service.
- Only perform servicing and maintenance tasks when the device is switched off.

### AUMA Service & Support

AUMA offer extensive service such as servicing and maintenance as well as customer product training. For the relevant contact addresses, please refer to <Addresses> in this document or to the Internet ([www.auma.com](http://www.auma.com)).

### 11.1 Preventive measures for servicing and safe operation

The following measures are required to ensure safe device operation:

#### 6 months after commissioning and then every year

- Carry out visual inspection:  
Cable entries, cable glands, blanking plugs, etc. have to be checked for correct tightness and sealing.  
Respect torques according to manufacturer's details.
- Check fastening screws between actuator and gearbox/valve for tightness. If required, fasten screws while applying the tightening torques as indicated in chapter <Assembly>.
- When rarely operated: Perform test run.

#### For enclosure protection IP 68

After continuous immersion:

- Check actuator.
- In case of ingress of water, locate leaks and repair, dry device correctly and check for proper function.

### 11.2 Maintenance

- Lubrication**
- In the factory, the gear housing is filled with grease.
  - Grease change is performed during maintenance
    - Generally after 4 to 6 years for modulating duty.
    - Generally after 6 to 8 years if operated frequently (open-close duty).
    - Generally after 10 to 12 years if operated rarely (open-close duty).
  - We recommend exchanging the seals when changing the grease.
  - No additional lubrication of the gear housing is required during operation.

### 11.3 Disposal and recycling

Our devices have a long lifetime. However, they have to be replaced at one point in time. The devices have a modular design and may, therefore, easily be separated and sorted according to materials used, i.e.:

- electronic scrap
- various metals
- plastics
- greases and oils

The following generally applies:

- Greases and oils are hazardous to water and must not be released into the environment.
- Arrange for controlled waste disposal of the disassembled material or for separate recycling according to materials.

- Observe the national regulations for waste disposal.

## 12. Technical data

**Information** The following technical data includes standard and optional features. For detailed information on the customer-specific version, refer to the order-relevant data sheet. This data sheet can be downloaded from the Internet at <http://www.auma.com> in German and English (indication of commission number required).

### 12.1 Features and functions of actuator

Type of duty <sup>1)</sup>	Standard: <ul style="list-style-type: none"> <li>SQ: Short-time duty S2 - 15 min</li> <li>SQR: Intermittent duty S4 - 25 %</li> </ul> Options: <ul style="list-style-type: none"> <li>SQ: Short-time duty S2 - 30 min</li> <li>SQR: Intermittent duty S4 - 50 %</li> <li>SQR: Intermittent duty S5 - 25 %</li> </ul>
Torque range	Refer to actuator name plate
Operating time for 90°	Refer to actuator name plate
Motor	Standard: 3-ph AC asynchronous motor, type IM B9 according to IEC/EN 60034 Part 1
Motor voltage and frequency	Refer to motor name plate Permissible variation of mains voltage: $\pm 10$ % Permissible variation of mains frequency: $\pm 5$ %
Insulation class	Standard: F, tropicalized Option: H, tropicalized
Motor protection	Standard: Thermoswitches (NC) Option: PTC thermistors (according to DIN 44082)
Motor heater (option)	Voltages: 110 – 120 V AC, 220 – 240 V AC or 400 V AC (externally supplied) Power depending on the size 12.5 – 25 W
Swing angle	Standard: Adjustable between 75° and < 105° Options: 15° to < 45°, 45° to < 75°, 105° to < 135°
Self-locking	Self-locking Part-turn actuators are self-locking, if the valve position cannot be changed from standstill while torque acts upon the output drive.
Manual operation	Manual drive for setting and emergency operation, handwheel does not rotate during electrical operation. Option: Handwheel lockable
Indication for manual operation (option)	Indication whether manual operation is active/not active via switch (1 change-over contact)
Connection to controls	AUMA plug/socket connector with screw-type connection
Coupling	Standard: Coupling without bore Options: Machined coupling with bore and keyway, square bore or bore with two-flats according to EN ISO 5211
Valve attachment	Dimensions according to EN ISO 5211
<b>Electronic control unit</b>	
Limit switching	Magnetic limit and torque transmitter MWG for 1 to 500 turns per stroke or 10 to 5,000 turns per stroke
Torque switching	Via MWG (like limit switching)
Position feedback signal, analogue (option)	Via MWG
Torque feedback signal, analogue (option)	Via MWG
Mechanical position indicator	Continuous indication, adjustable indicator disc with symbols OPEN and CLOSED
Heater in switch compartment	Standard: Resistance type heater, 5 W, 24 V DC, (internal supply)
Temperature for motor (option)	Temperature sensor PT 100
Temperature for gear housing (option)	Temperature sensor PT 100

- 1) For nominal voltage and 40 °C ambient temperature and an average load with 35 % of the maximum torque according to separate technical data. The type of duty must not be exceeded.

Technical data for handwheel activation switches	
Mechanical lifetime	10 <sup>6</sup> starts
<b>Silver plated contacts:</b>	
U min.	12 V DC
U max.	250 V AC
I max. AC current	3 A at 250 V (inductive load, cos phi = 0.8)
I max. DC current	3 A at 12 V (resistive load)

## 12.2 Features and functions of actuator controls

Power supply Mains frequency	For mains voltage and mains frequency, refer to name plates at the controls and the motor Permissible variation of the mains voltage: $\pm 10\%$ Permissible variation of the mains frequency: $\pm 5\%$ Option: Permissible variation of the mains voltage: $\pm 30\%$
External supply of the electronics (option)	24 V DC $+20\%$ / $-15\%$ Current consumption: Basic version approx. 250 mA, with options up to 500 mA The external power supply must have a reinforced insulation against the mains voltage in accordance with IEC 61010-1 and may only be supplied by a circuit limited to 150 VA in accordance with IEC 61010-1.
Current consumption	Current consumption of the controls depending on the mains voltage: For permissible variation of mains voltage by $\pm 10\%$ : <ul style="list-style-type: none"> <li>100 to 120 V AC = max. 740 mA</li> <li>208 to 240 V AC = max. 400 mA</li> <li>380 to 500 V AC = max. 250 mA</li> <li>515 to 690 V AC = max. 200 mA</li> </ul> For permissible variation of mains voltage by $\pm 30\%$ : <ul style="list-style-type: none"> <li>100 to 120 V AC = max. 1,200 mA</li> <li>208 to 240 V AC = max. 750 mA</li> <li>380 to 500 V AC = max. 400 mA</li> <li>515 to 690 V AC = max. 400 mA</li> </ul> Motor current consumption: Refer to motor name plate
Overvoltage category	Category III according to IEC 60634-4-443
Rated power	The controls are designed for the rated motor power, refer to motor name plate
Control	Standard: Via digital inputs OPEN, STOP, CLOSE, EMERGENCY (via opto-isolator, OPEN, STOP, CLOSE with one common), respect minimum pulse duration for modulating actuators Option: Additional enable inputs for directions OPEN and CLOSE
Voltage and current values for control inputs <sup>1)</sup>	Standard: 24 V DC, current consumption: approx. 10 mA per input Options: 48 V DC, current consumption: approx. 7 mA per input 60 V DC, current consumption: approx. 9 mA per input 110 V DC, current consumption: approx. 8 mA per input 115 V DC, current consumption: approx. 15 mA per input 115 V AC, current consumption: approx. 15 mA per input



Status signals	<p>Standard:</p> <ul style="list-style-type: none"> <li>6 programmable output contacts: <ul style="list-style-type: none"> <li>5 potential-free NO contacts with one common, max. 250 V AC, 1 A (resistive load) <ul style="list-style-type: none"> <li>Default configuration: End position CLOSED, end position OPEN, selector switch in REMOTE, torque fault CLOSE, torque fault OPEN</li> </ul> </li> <li>1 potential-free change-over contact, max. 250 V AC, 5 A (resistive load) <ul style="list-style-type: none"> <li>Default configuration: Collective fault signal (torque fault, phase failure, motor protection tripped)</li> </ul> </li> </ul> </li> </ul> <p>Options:</p> <ul style="list-style-type: none"> <li>6 programmable output contacts: <ul style="list-style-type: none"> <li>5 change-over contacts with one common, max. 250 V AC, 5 A (resistive load)</li> <li>1 potential-free change-over contact, max. 250 V AC, 5 A (resistive load)</li> </ul> </li> <li>12 programmable output contacts:<sup>2)</sup> <ul style="list-style-type: none"> <li>10 potential-free NO contacts, one common for respectively 5 contacts, max. 250 V AC, 1 A (resistive load)</li> <li>2 potential-free change-over contacts, max. 250 V AC, 5 A (resistive load)</li> </ul> </li> <li>6 programmable output contacts: <ul style="list-style-type: none"> <li>6 potential-free change-over contacts <b>without</b> one common, per contact max. 250 V AC, 5 A (resistive load)</li> </ul> </li> <li>10 programmable output contacts:<sup>2)</sup> <ul style="list-style-type: none"> <li>10 potential-free change-over contacts <b>without</b> one common, per contact max. 250 V AC, 5 A (resistive load)</li> </ul> </li> </ul> <p>All output signals must be supplied with the same potential.</p>
Position feedback signal	Galvanically isolated analogue output E2 = 0/4 – 20 mA (load max. 500 Ω)
Voltage output	<p>Standard:</p> <p>Auxiliary voltage 24 V DC, max. 100 mA for supply of the control inputs, galvanically isolated from internal voltage supply</p> <p>Option:</p> <p>Auxiliary voltage 115 V AC, max. 30 mA to supply the control inputs<sup>3)</sup>, galvanically isolated from internal voltage supply</p>
Local controls	<p>Standard:</p> <ul style="list-style-type: none"> <li>Selector switch LOCAL - OFF - REMOTE (lockable in all three positions)</li> <li>Push buttons OPEN, STOP, CLOSE, RESET</li> <li>6 indication lights: <ul style="list-style-type: none"> <li>End position CLOSED (yellow), torque fault CLOSE (red), motor protection tripped (red), torque fault OPEN (red), end position and running indication OPEN (green), Bluetooth (blue)</li> </ul> </li> <li>Graphic LC display, illuminated</li> </ul> <p>Options:</p> <ul style="list-style-type: none"> <li>Special colours for the 5 indication lights: <ul style="list-style-type: none"> <li>End position CLOSED (green), torque fault CLOSE (blue), torque fault OPEN (yellow), motor protection tripped (white), end position OPEN (red)</li> </ul> </li> </ul>
Bluetooth Communication interface	<p>Bluetooth class II chip, version 2.0 with a range up to 10 m in industrial environments. Supports the SPP Bluetooth profile (Serial Port Profile).</p> <p>Programming software:</p> <p>AUMA CDT, commissioning and diagnostic tool for windows based PCs, PDAs and smart phones</p>
Application functions	<p>Standard:</p> <ul style="list-style-type: none"> <li>Switch-off mode adjustable <ul style="list-style-type: none"> <li>Limit or torque seating for end position OPEN and end position CLOSED</li> </ul> </li> <li>Torque by-pass, adjustable up to 5 seconds (no torque monitoring during this time)</li> <li>Start and end of stepping mode as well as ON and OFF time (1 up to 1,800 seconds) can be programmed individually for directions OPEN and CLOSE.</li> <li>Any 8 intermediate positions between 0 and 100 %, reaction and signal behaviour programmable</li> </ul> <p>Options:</p> <ul style="list-style-type: none"> <li>Positioner <ul style="list-style-type: none"> <li>Position setpoint via analogue input E1 = 0/4 – 20 mA</li> <li>Automatic adaptation of the dead band (adaptive behaviour can be selected)</li> <li>Split Range operation</li> <li>MODE input for selecting between OPEN - CLOSE duty and modulating duty</li> </ul> </li> </ul>

Failure functions	<p>Standard:</p> <ul style="list-style-type: none"> <li>• EMERGENCY operation, behaviour programmable <ul style="list-style-type: none"> <li>- Digital input low active, reaction can be selected: Stop, move to end position CLOSED, move to end position OPEN, move to intermediate position</li> <li>- Torque monitoring can be by-passed during EMERGENCY operation.</li> <li>- Thermal protection can be by-passed during EMERGENCY operation (only in combination with thermoswitch in the actuator, not with PTC thermistor).</li> </ul> </li> </ul> <p>Options:</p> <ul style="list-style-type: none"> <li>• Enabling local controls via digital input Enable LOCAL. Thus, the actuator operation can be enabled or disabled via push buttons on the local controls.</li> <li>• Local Stop <ul style="list-style-type: none"> <li>- The actuator can be stopped via push button Stop of local controls if the selector switch is in position REMOTE. Not activated when leaving the factory.</li> </ul> </li> <li>• EMERGENCY stop button (latching) interrupts electrical operation irrespective of the selector switch position.</li> <li>• Interlock, enabling the operation commands OPEN or CLOSE via digital inputs Interlock OPEN or Interlock CLOSE</li> </ul>
Monitoring functions	<p>Standard:</p> <ul style="list-style-type: none"> <li>• Valve overload protection (adjustable), results in switching off and generates fault indication</li> <li>• Motor temperature monitoring (thermal monitoring), results in switching off and generates fault indication</li> <li>• Monitoring the heater within the actuator, generates warning signal</li> <li>• Monitoring of permissible on-time and number of starts (adjustable), generates warning signal</li> <li>• Operation time monitoring (adjustable), generates warning signal</li> <li>• Phase failure monitoring, results in switching off and generates fault indication</li> <li>• Automatic correction of the direction of rotation upon wrong phase sequence (3-phase AC current)</li> </ul>
Diagnostic functions	<ul style="list-style-type: none"> <li>• Electronic device ID with order and product data</li> <li>• Logging of operating data: A resettable counter and a lifetime counter each for: <ul style="list-style-type: none"> <li>- Motor running time, number of starts, torque switch trippings in end positions CLOSED, limit switch trippings in end position CLOSED, torque switch trippings in end position OPEN, limit switch trippings in end position OPEN, torque faults CLOSE, torque faults OPEN, motor protection trippings</li> </ul> </li> <li>• Time-stamped event report with setting, operation and fault history: <ul style="list-style-type: none"> <li>- Status signals in compliance with NAMUR recommendation NE 107: "Failure", "Function check", "Out of specification", "Maintenance required"</li> </ul> </li> <li>• Torque characteristics <ul style="list-style-type: none"> <li>- 3 torque characteristics (torque-travel characteristic) for opening and closing directions, can be saved separately. Torque characteristics stored can be shown on the display.</li> </ul> </li> </ul>
Electrical connection	<p>Standard:</p> <p>AUMA plug/socket connector (S) with screw-type connection and M-threads</p> <p>Options:</p> <ul style="list-style-type: none"> <li>• Pg-threads, NPT-threads, G-threads, special threads</li> <li>• Gold-plated control contacts (pins and sockets)</li> <li>• Parking frame for wall mounting of the disconnected plug</li> <li>• Protection cover for plug compartment (when plug is removed)</li> </ul>
Wiring diagram	Refer to name plate

- 1) All input signals must be supplied with the same potential.
- 2) Not possible for low temperature versions with heating system
- 3) Not possible in combination with PTC tripping device

Further options for Non-intrusive version with MWG in the actuator	
Setting limit and torque switching via the controls' local controls	
Torque feedback signal	Galvanically isolated analogue output E6 = 0/4 – 20 mA (max. load 500 Ω), only possible in combination with output contacts

### 12.3 Service conditions

Use	Indoor and outdoor use permissible
Mounting position	Any position
Installation altitude	≤ 2,000 m above sea level for > 2,000 m above sea level, please contact AUMA
Humidity	Up to 100 % relative humidity over the entire permissible temperature range
Ambient temperature	Standard: <ul style="list-style-type: none"> <li>• Open-close duty: –25 °C to +70 °C</li> <li>• Modulating duty: –25 °C to +60 °C</li> </ul> For actual version, refer to actuator/controls name plate.
Enclosure protection according to EN 60529	Standard: IP 68 with AUMA 3-phase AC motor/1-phase AC motor According to AUMA definition, enclosure protection IP 68 meets the following requirements: <ul style="list-style-type: none"> <li>• Depth of water: maximum 8 m head of water</li> <li>• Duration of continuous immersion in water: Max. 96 hours</li> <li>• Up to 10 operations during continuous immersion</li> <li>• Modulating duty is not possible during continuous immersion.</li> </ul> For actual version, refer to actuator/controls name plate.
Pollution degree	Pollution degree 4 (when closed) according to EN 50178
Vibration resistance according to IEC 60068–2–6	1 g, from 10 to 200 Hz Resistant to vibration during start-up or for failures of the plant. However, a fatigue strength may not be derived from this.
Corrosion protection	Standard: <ul style="list-style-type: none"> <li>• KS: Suitable for installation in industrial units, in water or power plants with a low pollutant concentration as well as for installation in occasionally or permanently aggressive atmosphere with a moderate pollutant concentration (e.g. wastewater treatments plants, chemical industry)</li> </ul> Options: <ul style="list-style-type: none"> <li>• KX: Suitable for installation in extremely aggressive atmospheres with high humidity and high pollutant concentration</li> <li>• KX-G : same as KX, however aluminium-free version (outer parts)</li> </ul>
Finish coating	Powder coating
Colour	Standard: AUMA silver-grey (similar to RAL 7037)
Lifetime	AUMA part-turn actuators meet or even exceed the lifetime requirements of EN 15714-2. Detailed information can be provided on request.
Weight	Refer to separate technical data

### 12.4 Accessories

Wall bracket <sup>1)</sup>	AUMATIC mounted separately from the actuator, including plug/socket connector. Connecting cables on request. Recommended for high ambient temperatures, difficult access, or in case of heavy vibration during service
Programming software for PC	AUMA CDT

1) Cable distance between actuator and AUMATIC max. 100 m. Requires separate data cable for MWG. If actuator and AUMATIC are separated at a later date, the max. cable length is 10 m.

### 12.5 Further information

EU Directives	<ul style="list-style-type: none"> <li>• Electromagnetic Compatibility (EMC): (2004/108/EC)</li> <li>• Low Voltage Directive: (2006/95/EC)</li> <li>• Machinery Directive: (2006/42/EC)</li> </ul>
---------------	--

**13.1 Part-turn actuators SQ 05.2 – SQ 14.2/SQR 05.2 – SQR 14.2**



**Information:** Please state type and commission no. of the device (see name plate) when ordering spare parts. Only original AUMA spare parts should be used. Failure to use original spare parts voids the warranty and exempts AUMA from any liability. Delivered spare parts may slightly vary from the representation in these instructions.

No.	Designation	Type	No.	Designation	Type
001.0	Housing	Sub-assembly	525.0	Coupling	Sub-assembly
003.0	Output drive flange with end stop	Sub-assembly	539.0	Screw plug	Sub-assembly
005.0	Drive shaft	Sub-assembly	542.0	Handwheel with ball handle	Sub-assembly
005.1	Motor coupling on output drive shaft		553.0	Mechanical position indicator	Sub-assembly
005.3	Manual drive coupling		554.0	Socket carrier with motor cable harness	Sub-assembly
006.0	Worm wheel		556.0	Potentiometer for position transmitter	Sub-assembly
009.0	Planetary gearing for manual drive	Sub-assembly	556.1	Potentiometer without slip clutch	Sub-assembly
017.0	Torque lever	Sub-assembly	557.0	Heater	Sub-assembly
018.0	Gear segment		558.0	Blinker transmitter including pins at wires (without impulse disc and insulation plate)	Sub-assembly
019.0	Crown wheel		559.0–1	Control unit with torque switching heads and switches	Sub-assembly
022.0	Drive pinion II for torque switching	Sub-assembly	559.0–2	Control unit with magnetic limit and torque transmitter (MWG) for Non-intrusive version in combination with AUMATIC integral controls	Sub-assembly
023.0	Output drive wheel for limit switching	Sub-assembly	560.0–1	Switch stack for direction OPEN	Sub-assembly
024.0	Drive wheel for limit switching	Sub-assembly	560.0–2	Switch stack for direction CLOSE	Sub-assembly
025.0	Locking plate	Sub-assembly	560.1	Switch for limit/torque	Sub-assembly
058.0	Wire for protective earth (pin)	Sub-assembly	560.2	Switch case	
070.0	Motor (VD motor incl. no. 079.0)	Sub-assembly	566.0	Position transmitter RWG	Sub-assembly
079.0	Planetary gear for motor drive (SQ/SQR 05.2 – 14.2 for VD motor)	Sub-assembly	566.1	Potentiometer for RWG without slip clutch	Sub-assembly
155.0	Reduction gearing	Sub-assembly	566.2	Electronic board RWG	Sub-assembly
500.0	Cover for switch compartment	Sub-assembly	566.3	Wire harness for RWG	Sub-assembly
501.0	Socket carrier (complete with sockets)	Sub-assembly	567.1	Slip clutch for potentiometer/RWG	Sub-assembly
502.0	Pin carrier without pins	Sub-assembly	583.0	Motor coupling on motor shaft	Sub-assembly
503.0	Socket for control	Sub-assembly	583.1	Pin for motor coupling	
504.0	Socket for motor	Sub-assembly	584.0	Retaining spring for motor coupling	Sub-assembly
505.0	Pin for controls	Sub-assembly	596.0	Output drive flange with end stop	Sub-assembly
506.0	Pin for motor	Sub-assembly	S1	Seal kit, small	Set
507.0	Plug cover	Sub-assembly	S2	Seal kit, large	Set

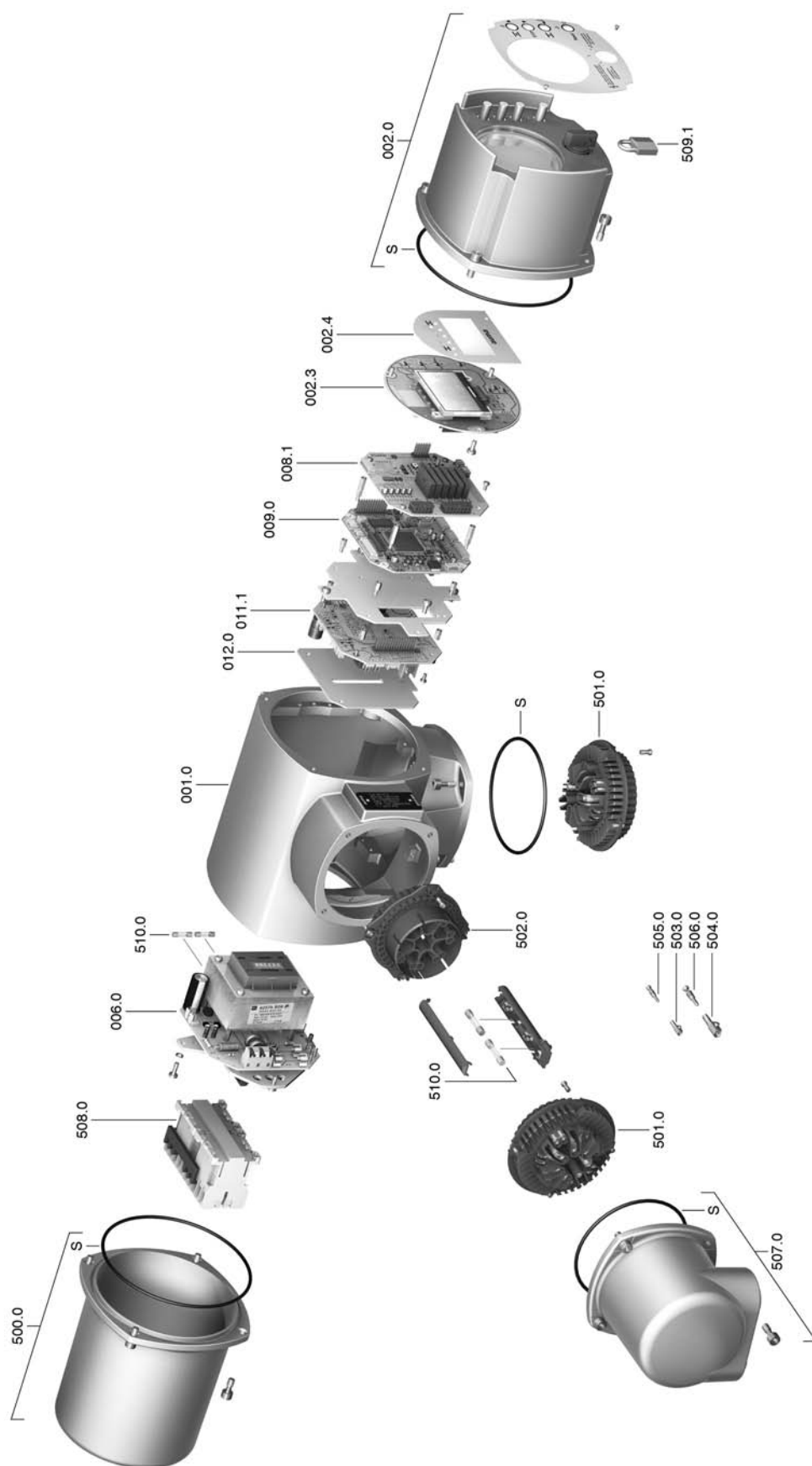
**13.2 Actuator controls AUMATIC AC 01.2**

**Information:** Please state type and commission no. of the device (see name plate) when ordering spare parts. Only original AUMA spare parts should be used. Failure to use original spare parts voids the warranty and exempts AUMA from any liability. Delivered spare parts may slightly vary from the representation.

No.	Designation	Type
001.0	Housing	Sub-assembly
002.0	Local controls	Sub-assembly
002.3	Local controls board	Sub-assembly
002.4	Display faceplate	Sub-assembly
006.0	Power supply	Sub-assembly
008.1–1	I/O board	Sub-assembly
009.0	Logic board	Sub-assembly
011.1	Relay board	Sub-assembly
012.0	Option board	Sub-assembly
500.0	Cover	Sub-assembly
501.0	Socket carrier complete with sockets	Sub-assembly
502.0	Pin carrier without pins	Sub-assembly
503.0	Socket for controls	Sub-assembly
504.0	Socket for motor	Sub-assembly
505.0	Pin for controls	Sub-assembly
506.0	Pin for motor	Sub-assembly
507.0	Plug cover	Sub-assembly
508.0	Switchgear	Sub-assembly
509.1	Padlock	
510.0	Fuse kit	Sub-assembly
S	Seal kit	Set



**14. Certificates****14.1 Declaration of Incorporation and EC Declaration of Conformity**

AUMA Riester GmbH & Co. KG  
Aumastr. 1  
79379 Müllheim, Germany  
www.auma.com

Tel +49 7631 809-0  
Fax +49 7631 809-1250  
Riester@auma.com



**Original Declaration of Incorporation of Partly Completed Machinery  
(EC Directive 2006/42/EC) and EC Declaration of Conformity in compliance with the  
Directives on EMC and Low Voltage**

for electric AUMA part-turn actuators of the type ranges **SQ 05.2 – SQ 14.2** and **SQR 05.2 – SQR 14.2**  
in versions **AUMA NORM, AUMA SEMIPACT, AUMA MATIC** or **AUMATIC**.

AUMA Riester GmbH & Co. KG as manufacturer declares herewith, that the above mentioned part-turn actuators meet the following basic requirements of the EC Machinery Directive 2006/42/EC: Annex I, articles 1.1.2, 1.1.3, 1.1.5, 1.2.1; 1.2.6, 1.3.1, 1.3.7, 1.5.1, 1.6.3, 1.7.1, 1.7.3, 1.7.4

The following harmonised standards within the meaning of the Machinery Directive have been applied:

EN 12100-1: 2003	ISO 5211: 2001
EN 12100-2: 2003	EN 60204-1: 2006

With regard to the partly completed machinery, the manufacturer commits to submitting the documents to the competent national authority via electronic transmission upon request. The relevant technical documentation pertaining to the machinery described in Annex VII, part B has been prepared.

AUMA part-turn actuators are designed to be installed on industrial valves. AUMA part-turn actuators must not be put into service until the final machinery into which they are to be incorporated has been declared in conformity with the provisions of the EC Directive 2006/42/EC.

Authorised person for documentation: Peter Malus, Aumastrasse 1, D-79379 Müllheim

As partly completed machinery, the part-turn actuators further comply with the requirements of the following directives and the respective approximation of national laws as well as the respective harmonised standards as listed below:

**(1) Directive relating to Electromagnetic Compatibility (EMC) (2004/108/EC)**

EN 61000-6-4: 2007 + A1: 2011  
EN 61000-6-2: 2005

**(2) Low Voltage Directive (2006/95/EC)**

EN 60204-1: 2006	EN 60034-1: 2010
EN 50178: 1997	EN 61010-1: 2001

Müllheim, 2013-05-01

H. Newerla, General Management

This declaration does not contain any guarantees. The safety instructions in product documentation supplied with the devices must be observed. Non-concerted modification of the devices voids this declaration.

Y005.536/002/en







## Index

### A

Accessories (electrical connection)	19
Actual value - indication on display	31
Actuator operation at the local controls	22
Actuator operation from remote	23
Ambient temperature	8 , 59
Analogue signals	37
Applications	5
Assembly	12

### C

Cable set	19
Commission number	8 , 9
Commissioning	5
Commissioning (indications on display)	29
Connecting cable	19
Control	9 , 9
Corrective action	47
Corrosion protection	11 , 59
Cross sections	16
Current consumption	15

### D

Declaration of Incorporation	64
Device type	9 , 9
Digital outputs	37
Direct display via ID	25
Direction of rotation	45
Directives	5
Display (indications)	29
Disposal	53
Double sealed	21

### E

EC Declaration of Conformity	64
EMC	15
Earth connection	21
Electrical connection	15
Enclosure protection	8 , 59
End stops	38
Error - indication on display	29

### F

Failure - indication on display	35
Fault - indication on display	33
Flange size	9
Function check - indication on display	34

### H

Handwheel	12
-----------	----

### I

Identification	8
Indication lights	36
Indications	29
Indications on display	29
Indicator disc	35 , 45
Inspection record	9
Intermediate frame	21
Intermediate position indication via LEDs	36
Intrusive	10

### L

LEDs (indication lights)	36
Language in the display	27
Local actuator operation	22
Local control	22
Local controls	22
Local setting	23
Lubrication	53

### M

Main menu	24
Mains frequency	16
Mains voltage	16
Maintenance	5 , 53 , 53
Maintenance required - indication on display	34
Manual operation	22
Mechanical position indicator	35 , 45
Menu navigation	23
Motor heater	18
Motor operation	22
Multiport valve - Indications on display	32

### N

Name plate	8 , 16
Network types	15
Non-Intrusive	10
Not ready REMOTE - indication on display	33

### O

Operating time	8
Operation	5 , 22
Operation commands - indications on display	31
Order number	8 , 9
Out of specification - indication on display	34
Output contacts	37

<b>P</b>		<b>V</b>	
Packaging	11	Valve position - indication on display	30
Parking frame	20		
Password	25	<b>W</b>	
Password change	26	Wall bracket	19
Password entry	26	Warnings - indication on display	33
Position indicator	45	Wiring diagram	9 , 9 , 15
Positioner - indication on display	32	Works number	9
Power supply	15 , 16	<b>Y</b>	
Protection cover	21	Year of manufacture	9
Protection on site	15	Year of production	9
Protective measures	5		
<b>Q</b>			
Qualification of staff	5		
<b>R</b>			
Range of application	5		
Recycling	53		
Remote actuator operation	23		
Running indication	35		
<b>S</b>			
Safety instructions	5		
Safety instructions/warnings	5		
Serial number	8 , 9		
Service	53		
Service conditions	59		
Servicing	53		
Setpoint - indication on display	32		
Short-circuit protection	15		
Signals	37		
Signals (analogue)	37		
Size	9 , 9		
Spare parts	60		
Standards	5		
Status menu	24		
Status signals	37		
Storage	11		
Supply networks	15		
Support	53		
<b>T</b>			
Technical data	55		
Terminal plan	15		
Test run	44		
Torque - indication on display	31		
Torque range	8		
Torque switching	41		
Transport	11		
Type (device type)	9 , 9		
Type designation	8		
Type of current	16		
Type of lubricant	8		
<b>U</b>			
User level	25		

## Europe

### AUMA Riester GmbH & Co. KG

Plant Müllheim  
**DE 79373 Müllheim**  
 Tel +49 7631 809 - 0  
 Fax +49 7631 809 - 1250  
 riester@auma.com  
 www.auma.com

Plant Ostfildern - Nellingen  
**DE 73747 Ostfildern**  
 Tel +49 711 34803 - 0  
 Fax +49 711 34803 - 3034  
 riester@wof.auma.com

Service-Center Köln  
**DE 50858 Köln**  
 Tel +49 2234 2037 - 900  
 Fax +49 2234 2037 - 9099  
 service@sck.auma.com

Service-Center Magdeburg  
**DE 39167 Niederndodeleben**  
 Tel +49 39204 759 - 0  
 Fax +49 39204 759 - 9429  
 Service@scm.auma.com

Service-Center Bayern  
**DE 85386 Eching**  
 Tel +49 81 65 9017- 0  
 Fax +49 81 65 9017- 2018  
 Riester@scb.auma.com

AUMA Armaturentriebe GmbH  
**AT 2512 Tribuswinkel**  
 Tel +43 2252 82540  
 Fax +43 2252 8254050  
 office@auma.at  
 www.auma.at

AUMA (Schweiz) AG  
**CH 8965 Berikon**  
 Tel +41 566 400945  
 Fax +41 566 400948  
 RettichP.ch@auma.com

AUMA Servopohony spol. s.r.o.  
**CZ 250 01 Brandýs n.L.-St.Boleslav**  
 Tel +420 326 396 993  
 Fax +420 326 303 251  
 auma-s@auma.cz  
 www.auma.cz

OY AUMATOR AB  
**FI 02230 Espoo**  
 Tel +358 9 5840 22  
 Fax +358 9 5840 2300  
 auma@aumator.fi  
 www.aumator.fi

AUMA France S.A.R.L.  
**FR 95157 Taverny Cedex**  
 Tel +33 1 39327272  
 Fax +33 1 39321755  
 info@auma.fr  
 www.auma.fr

AUMA ACTUATORS Ltd.  
**UK Clevedon, North Somerset BS21 6TH**  
 Tel +44 1275 871141  
 Fax +44 1275 875492  
 mail@auma.co.uk  
 www.auma.co.uk

AUMA ITALIANA S.r.l. a socio unico  
**IT 20023 Cerro Maggiore (MI)**  
 Tel +39 0331 51351  
 Fax +39 0331 517606  
 info@auma.it  
 www.auma.it

AUMA BENELUX B.V.  
**NL 2314 XT Leiden**  
 Tel +31 71 581 40 40  
 Fax +31 71 581 40 49  
 office@auma.nl  
 www.auma.nl

AUMA Polska Sp. z o.o.  
**PL 41-219 Sosnowiec**  
 Tel +48 32 783 52 00  
 Fax +48 32 783 52 08  
 biuro@auma.com.pl  
 www.auma.com.pl

OOO Priwody AUMA  
**RU 124365 Moscow a/ya 11**  
 Tel +7 495 221 64 28  
 Fax +7 495 221 64 38  
 aumarussia@auma.ru  
 www.auma.ru

ERICHs ARMATUR AB  
**SE 20039 Malmö**  
 Tel +46 40 311550  
 Fax +46 40 945515  
 info@erichsarmatur.se  
 www.erichsarmatur.se

GRØNBECH & SØNNER A/S  
**DK 2450 København SV**  
 Tel+45 33 26 63 00  
 Fax+45 33 26 63 21  
 GS@g-s.dk  
 www.g-s.dk

IBEROPLAN S.A.  
**ES 28027 Madrid**  
 Tel+34 91 3717130  
 Fax+34 91 7427126  
 iberoplan@iberoplan.com

D. G. Bellos & Co. O.E.  
**GR 13671 Acharnai Athens**  
 Tel+30 210 2409485  
 Fax+30 210 2409486  
 info@dgbellos.gr

SIGURD SØRUM AS  
**NO 1300 Sandvika**  
 Tel+47 67572600  
 Fax+47 67572610  
 post@sigum.no

INDUSTRA  
**PT 2710-297 Sintra**  
 Tel+351 2 1910 95 00  
 Fax+351 2 1910 95 99  
 industria@talis-group.com

Auma Endüstri Kontrol Sistemleri Limited  
 irketi  
**TR 06810 Ankara**  
 Tel+90 312 217 32 88  
 Fax+90 312 217 33 88  
 Servis@auma.com.tr  
 www.megaendustri.com.tr

AUMA Technology utomations Ltd.  
**UA 02099 Kiyiv**  
 Tel+38 044 586-53-03  
 Fax+38 044 586-53-03  
 auma-tech@aumatech.com.ua

## Africa

AUMA South Africa (Pty) Ltd.  
**ZA 1560 Springs**  
 Tel +27 11 3632880  
 Fax +27 11 8185248  
 aumasa@mweb.co.za

A.T.E.C.  
**EG Cairo**  
 Tel +20 2 23599680 - 23590861  
 Fax +20 2 23586621  
 contactus@atec-eg.com

CMR Contrôle Maintenance Régulation  
**TN 1002 Tunis**  
 Tel +216 71 903 577  
 Fax +216 71 903 575  
 instrum@cmr.com.tn  
 www.cmr-tunisie.net

MANZ INCORPORATED LTD.  
**NG Port Harcourt**  
 Tel +234-84-462741  
 Fax +234-84-462741  
 mail@manzincorporated.com  
 www.manzincorporated.com

## America

AUMA ACTUATORS INC.  
**US PA 15317 Canonsburg**  
 Tel +1 724-743-AUMA (2862)  
 Fax +1 724-743-4711  
 mailbox@auma-usa.com  
 www.auma-usa.com

AUMA Argentina Representative Office  
**AR 1609 Boulogne**  
 Tel/Fax +54 232 246 2283  
 contacto@aumaargentina.com.ar

AUMA Automação do Brasil Ltda.  
**BR São Paulo**  
 Tel +55 11 4612-3477  
 contato@auma-br.com

AUMA Chile Representative Office  
**CL 9500414 Buin**  
 Tel +56 2 821 4108  
 Fax +56 2 281 9252  
 aumachile@adsl.tie.cl

TROY-ONTOR Inc.  
**CA L4N 8X1 Barrie Ontario**  
 Tel +1 705 721-8246  
 Fax +1 705 721-5851  
 troy-ontor@troy-ontor.ca

Ferrostaal de Colombia Ltda.  
**CO Bogotá D.C.**  
 Tel +57 1 401 1300  
 Fax +57 1 416 5489  
 dorian.hernandez@ferrostaal.com  
 www.ferrostaal.com

PROCONTIC Procesos y Control  
 Automático  
**EC Quito**  
 Tel +593 2 292 0431  
 Fax +593 2 292 2343  
 info@procontic.com.ec

Corsusa International S.A.C.  
**PE Miraflores - Lima**  
 Tel +511444-1200 / 0044 / 2321  
 Fax +511444-3664  
 corsusa@corsusa.com  
 www.corsusa.com

PASSCO Inc.  
**PR 00936-4153 San Juan**  
 Tel +18 09 78 77 20 87 85  
 Fax +18 09 78 77 31 72 77  
 Passco@prtc.net

Suplibarca  
**VE Maracaibo Estado, Zulia**  
 Tel +58 261 7 555 667  
 Fax +58 261 7 532 259  
 suplibarca@intercable.net.ve

## Asia

AUMA Actuators (Tianjin) Co., Ltd.  
**CN 300457 Tianjin**  
 Tel +86 22 6625 1310  
 Fax +86 22 6625 1320  
 mailbox@auma-china.com  
 www.auma-china.com

AUMA INDIA PRIVATE LIMITED  
**IN 560 058 Bangalore**  
 Tel +91 80 2839 4656  
 Fax +91 80 2839 2809  
 info@auma.co.in  
 www.auma.co.in

AUMA JAPAN Co., Ltd.  
**JP 211-0016 Nakaharaku, Kawasaki-shi Kanagawa**  
 Tel +81 44 863 8371  
 Fax +81 44 863 8372  
 mailbox@auma.co.jp  
 www.auma.co.jp

AUMA ACTUATORS (Singapore) Pte Ltd.  
**SG 569551 Singapore**  
 Tel +65 6 4818750  
 Fax +65 6 4818269  
 sales@auma.com.sg  
 www.auma.com.sg

AUMA Actuators Middle East W.L.L.  
**AE 15268 Salmabad 704**  
 Tel +973 17877377  
 Fax +973 17877355  
 Naveen.Shetty@auma.com

PERFECT CONTROLS Ltd.  
**HK Tsuen Wan, Kowloon**  
 Tel +852 2493 7726  
 Fax +852 2416 3763  
 joeip@perfectcontrols.com.hk

DW Controls Co., Ltd.  
**KR 153-702 Seoul**  
 Tel +82 2 2624 3400  
 Fax +82 2 2624 3401  
 sichoi@actuatorbank.com  
 www.actuatorbank.com

Sunny Valves and Intertrade Corp. Ltd.  
**TH 10120 Yannawa Bangkok**  
 Tel +66 2 2400656  
 Fax +66 2 2401095  
 sunnyvalves@inet.co.th  
 www.sunnyvalves.co.th/

Top Advance Enterprises Ltd.  
**TW Jhonghe City Taipei Hsien (235)**  
 Tel +886 2 2225 1718  
 Fax +886 2 8228 1975  
 support@auma-taiwan.com.tw  
 www.auma-taiwan.com.tw

## Australia

BARRON GJM Pty. Ltd.  
**AU NSW 1570 Artarmon**  
 Tel +61 294361088  
 Fax +61 294393413  
 info@barron.com.au  
 www.barron.com.au



AUMA Riester GmbH & Co. KG  
P.O.Box 1362  
**D 79373 Muellheim**  
Tel +49 7631 809 - 0  
Fax +49 7631 809 - 1250  
riester@auma.com  
www.auma.com